



VERTUO POP+



NESPRESSO

CLICK AND CHOOSE YOUR LANGUAGE

EN

FR

ES



SAFETY PRECAUTIONS



OVERVIEW



CONNECTIVITY



FIRST USE



COFFEE PREPARATION



ADAPT YOUR COFFEE VOLUME



CLEANING



DESCALING



EMPTYING



MACHINE SETTINGS



BLINKING SUMMARY



TROUBLESHOOTING



SPECIFICATIONS

SAFETY PRECAUTIONS

CAUTION: Before operating your coffee machine, please refer to the safety instructions leaflet to avoid any possible harm and damage.

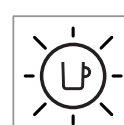
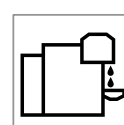
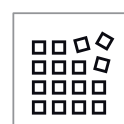
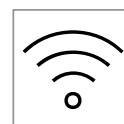
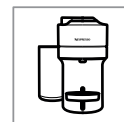

OVERVIEW

MACHINE OVERVIEW

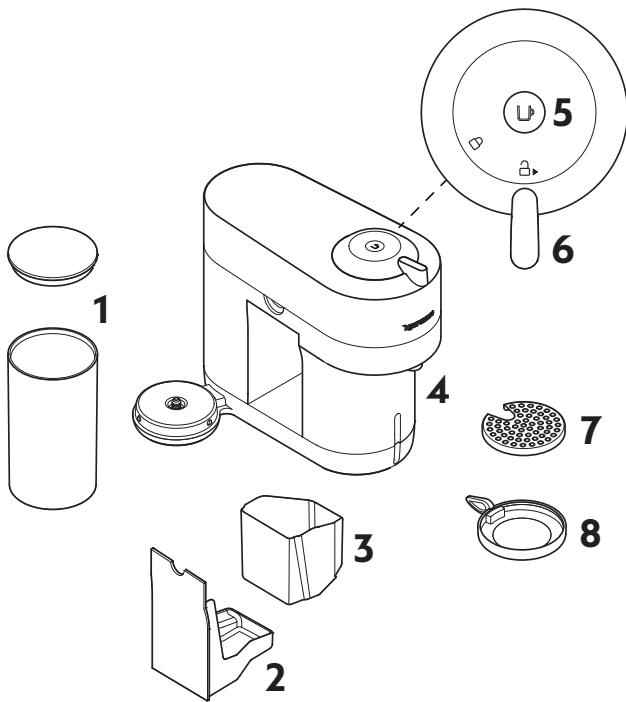

- 1 Water tank and lid
- 2 Drip tray
- 3 Container for used capsules
- 4 Coffee outlet
- 5 ON/OFF and coffee button
- 6 Locking/Unlocking lever
- 7 Drip grid
- 8 Adjustable cup support

PACKAGING CONTENT



- 1 Coffee machine
- 2 **Nespresso** capsules set
- 3 **Nespresso** welcome booklet
- 4 Safety instructions
- 5 Quick Start Guide
- 6 Warranty

4 + 5 + 6

i Unboxing: Some dust may be present on the surface of the machine due to the recycled materials used in the packaging. This is not dangerous, simply clean with a soft tissue.

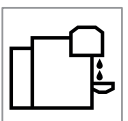
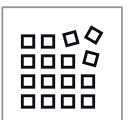

OPEN / CLOSE

OPEN

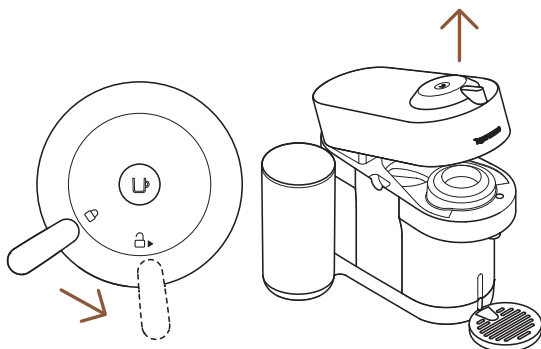

CLOSE

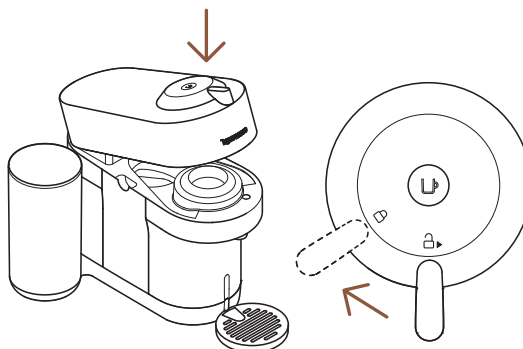

THE VERTUO SYSTEM

SUITABLE CAPSULES



S

Espresso

(40 ml / 1.4 oz)



M

Double Espresso

(80 ml / 2.8 oz)

Gran Lungo

(150 ml / 5.1 oz)



L

Mug

(230 ml / 7.8 oz)



XL

Alto, Cold Brew Style

(355 ml / 12.5 oz)

Carafe

(535 ml / 18.8 oz)

ACCESSORIES



Suitable accessories



Espresso



Double Espresso



Gran Lungo



Mug



Reveal Glass



Not suitable accessories



Alto



Carafe

Discover our full accessory collection on www.nespresso.com

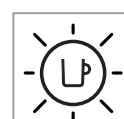
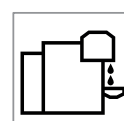
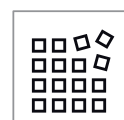
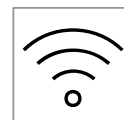

CONNECTIVITY

WHY SHOULD YOU PAIR YOUR VERTUO POP+ MACHINE?

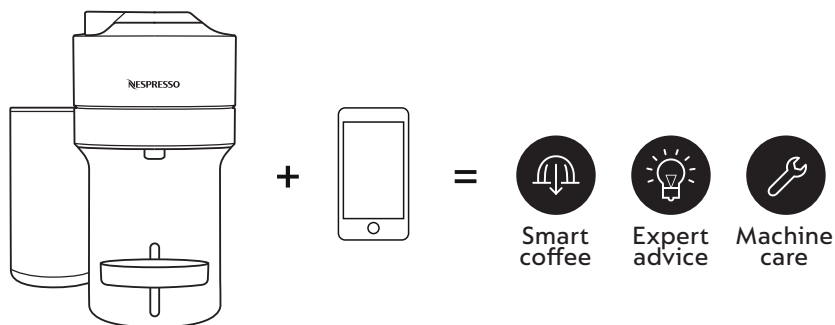

BENEFITS OF CONNECTING YOUR VERTUO POP+ MACHINE

- **Smart Coffee:** Enjoy the latest coffee innovations from **Nespresso** by always keeping your machine up to date.
- **Expert advices:** Receive real-time tips with step by step instructions for descaling, rinsing and cleaning your machine.
- **Machine care:** Get support and tutorials for your machine care via your smartphone.

HOW TO CONNECT YOUR VERTUO POP+ MACHINE?

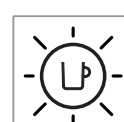
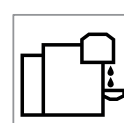
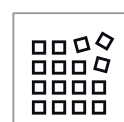
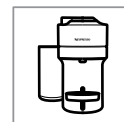



1 Download or update the **Nespresso** App.

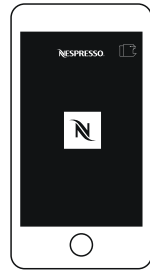

2 Launch the **Nespresso** App on your smartphone or your tablet.

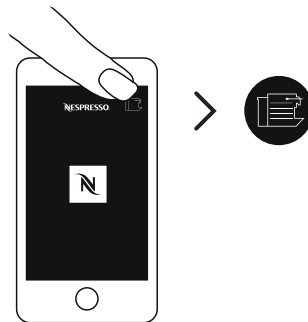

3 Click on the machine icon at the top right of your screen.

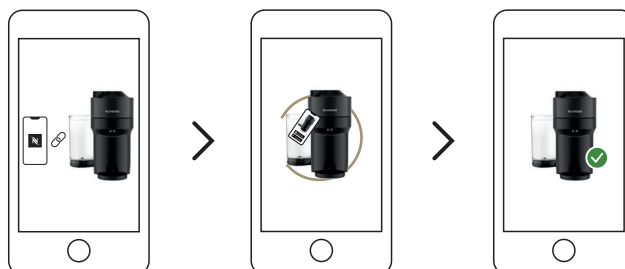

4 Follow the instructions via the **Nespresso** App.

* AppStore® is a trademark of Apple Inc., registered in the U.S. and other countries.
 ** Google Play and the Google Play logo are trademarks of Google LLC.



FIRST USE

ON / OFF

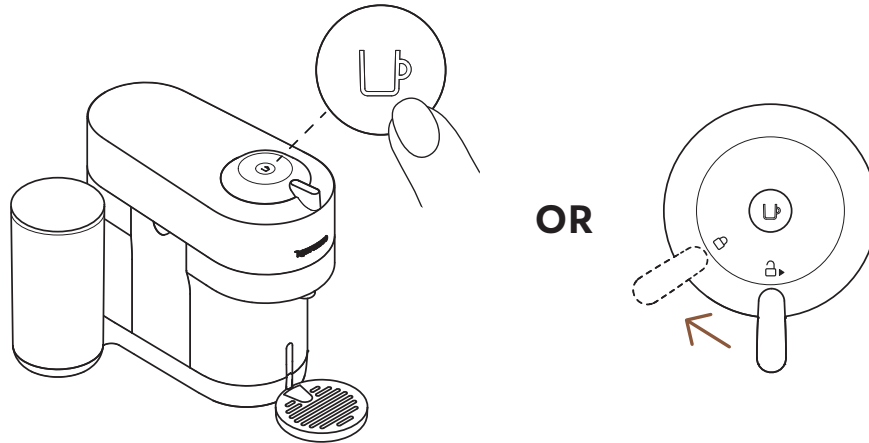

ON

Once the machine is plugged in, turn on by pressing once on the button or by closing the lever in the lock position (with the head closed).

- i** The light will blink for approximately 30 seconds while the machine is heating up. Once the light is steady, the machine is ready to be used.

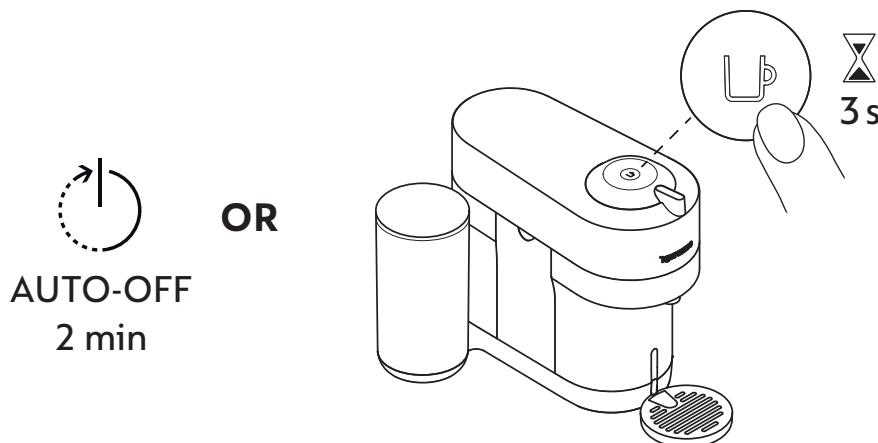

OFF

To save energy, the machine will turn off automatically after 2 minutes of non-use.

- i** The machine can be turned “OFF” manually at any time (when not in use) by pressing and holding the button for 3 seconds.

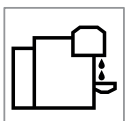
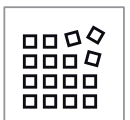

FIRST RINSING

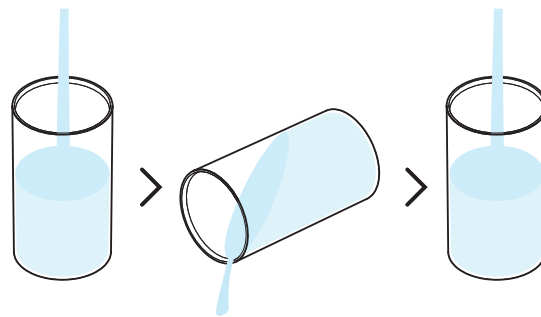

- 1** Rinse the water tank before filling it with only fresh potable water.

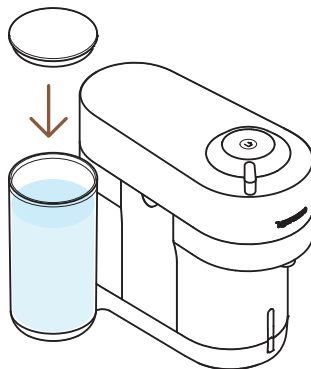

- 2** Close the water tank with the lid and put the water tank back in position on the machine.



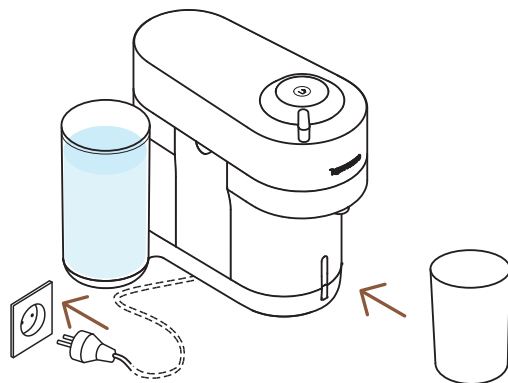

- 3** Plug the power cord, remove the cup support and place an empty container (at least 1 L / 34 oz) under the coffee outlet.

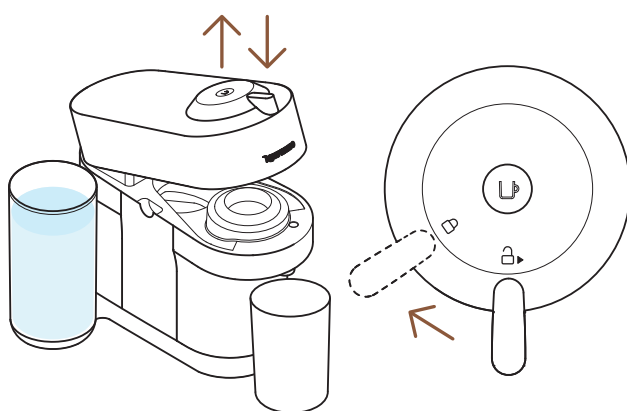

- 4** Open and close the machine. Ensure the lever is in lock position.

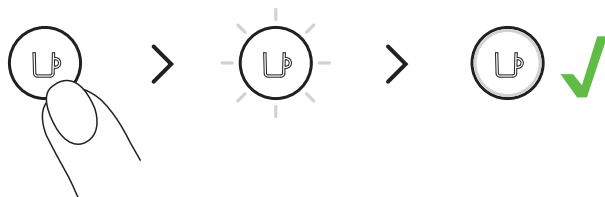

- 5** Turn on the machine by clicking on the button once.

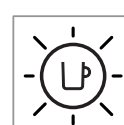
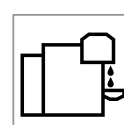
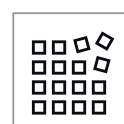
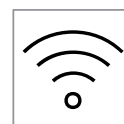
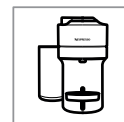

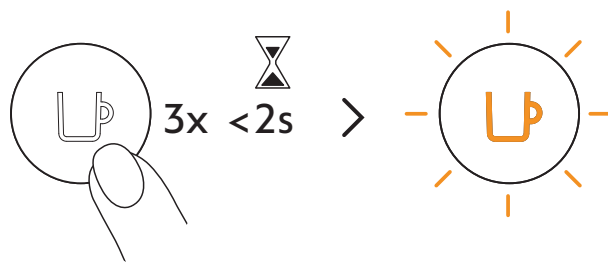

6 Press the button 3 times within 2 seconds.

i The machine will start rinsing. This procedure may take up to 7 minutes.

CAUTION: First read the safety precautions to avoid risks of fatal electrical shock and fire. Please ensure ground continuity when plugging the machine in the power outlet.

i When unpacking the machine, remove the plastic films.

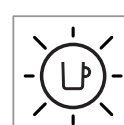
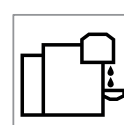
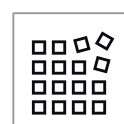
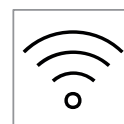
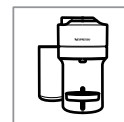

COFFEE PREPARATION

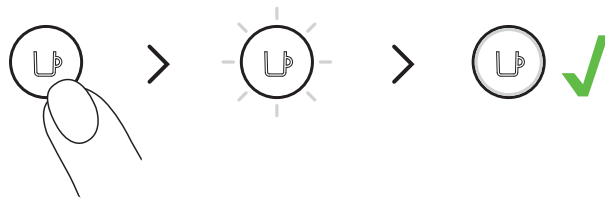

- 1 Turn on your machine by clicking once on the button or by closing the lever towards the lock position.

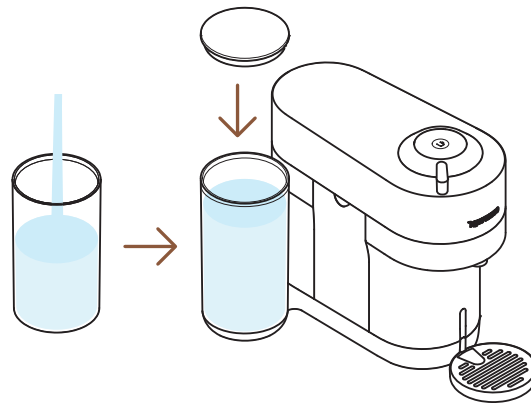

- 2 Fill the water tank with fresh potable water and put it back in position.

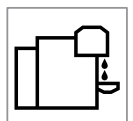
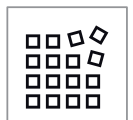

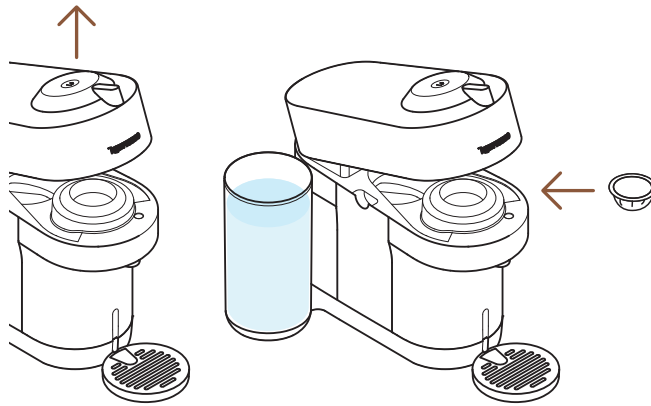

- 3** Open the machine and insert a Vertuo capsule.

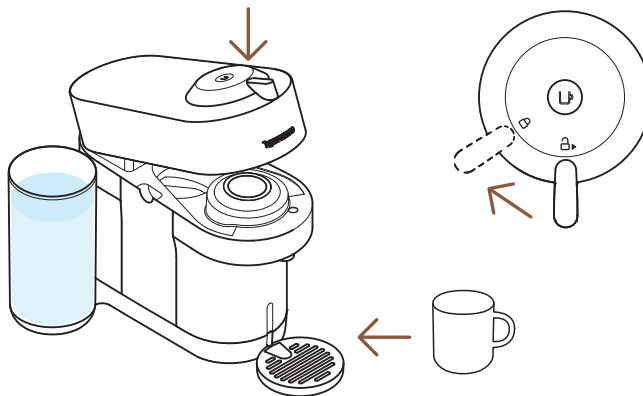

- 4** Close the machine by turning the lever until the lock position and place a cup. The cup support can be adjusted to accommodate your cup size.

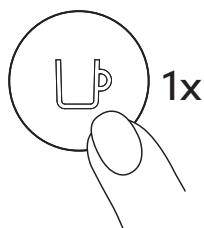

- 5** Start brewing by clicking on the button once.

NOTE: water may accumulate inside the machine's head, please dry visible parts with a clean dry cloth.

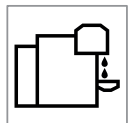
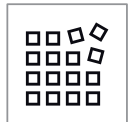

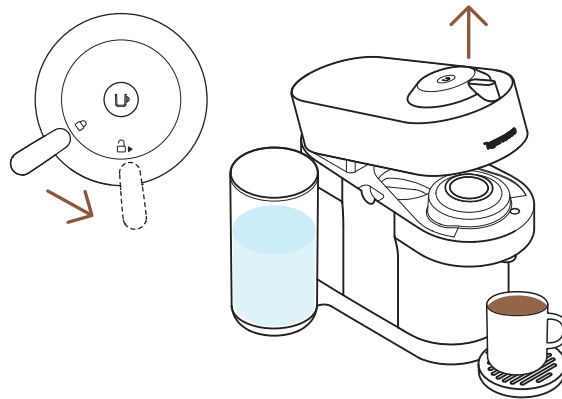

6 When the coffee stops brewing, open the machine by turning the lever towards the unlock position, eject the capsule and enjoy your coffee.

DISCOVER OUR CONCENTRATED EXTRACTION FOR BARISTA RECIPES

With this machine, **Nespresso** offers you a specific function to concentrate your coffee extractions to create your own recipes.

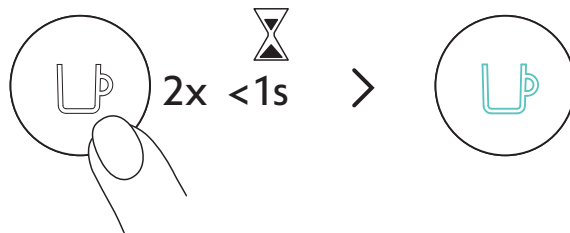

With your machine on, quickly click 2 times on the coffee button. It will blink turquoise and your coffee brew will be concentrated, enhancing the coffee taste in recipes with add-ons (milk, creamer, over ice...).

40 ml / 1.4 oz	80 ml / 2.7 oz	150 ml / 5.1 oz	230 ml / 7.8 oz	
∨	∨	∨	∨	
25 ml / 0.85 oz	40 ml / 1.4 oz	40 ml / 1.4 oz	80 ml / 2.7 oz	

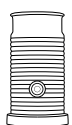

Discover how to upgrade your machine with our Aeroccino range on www.nespresso.com

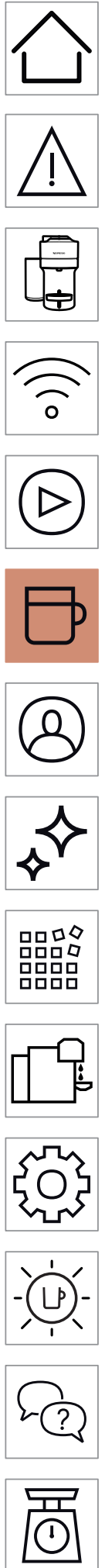

ADAPT YOUR COFFEE VOLUMES

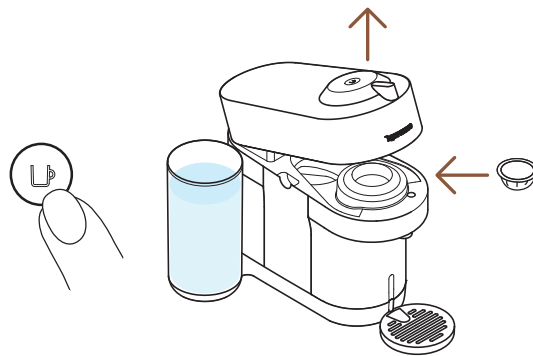

- 1** Turn on the machine by clicking on the button once, open the machine and insert the capsule you want to brew.

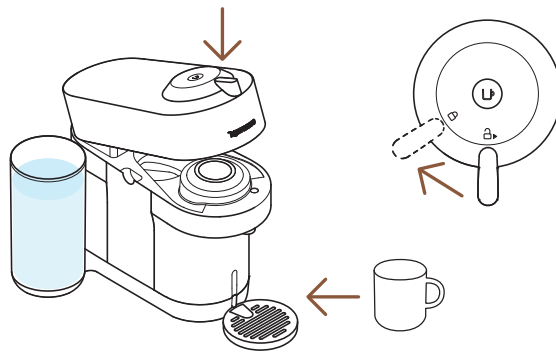

- 2** Close the machine, turn the lever towards the lock position and place a cup.

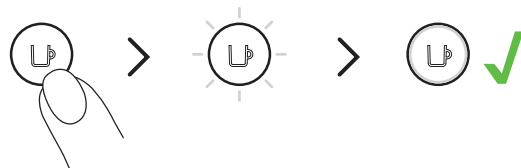

- 3** Press and hold the button until the desired volume is reached. The new water volume is now programmed for the capsule type used during the setting.

- i** The programming is specific to each capsule type. Cup sizes may be programmed from 20 ml / 0.7 oz to 535 ml / 18 oz.

NOTE: Once a customer-specific volume is programmed by the user, every time that capsule type is inserted in the machine, the preparation will stop at the user-programmed cup size. If you wish to come back to the default parameters see the paragraph **“Reset to factory settings”**.



CLEANING

Clean your machine on a monthly basis, when you start having coffee residue inside the machine head or after a long period of non-use.

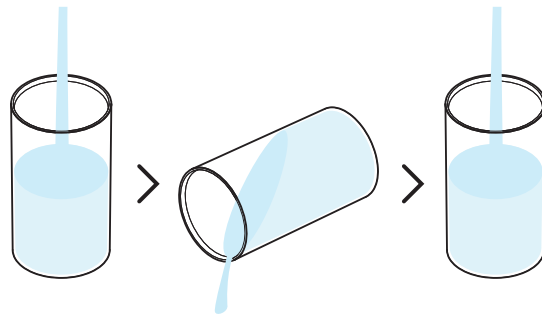

- 1** Rinse and clean the water tank and the lid before filling it with fresh potable water.

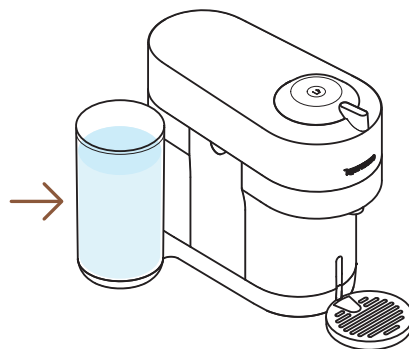

- 2** Put the water tank back in position on the machine.

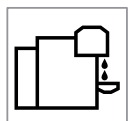
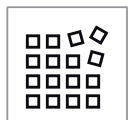

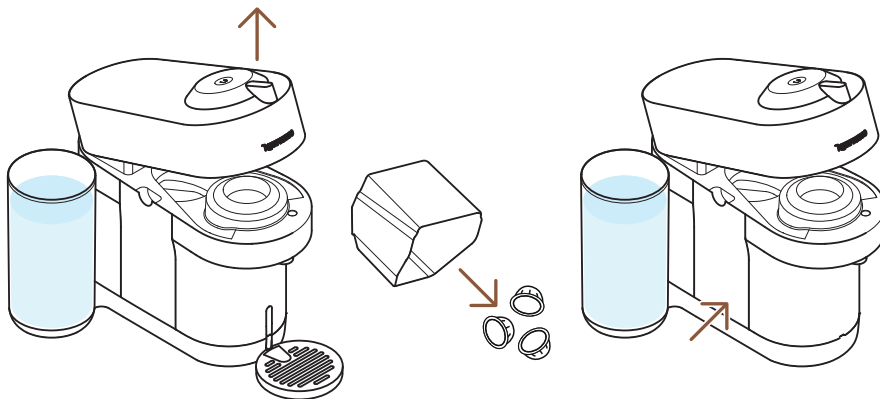

- 3** Open the machine and let the used capsule be ejected. Empty the capsule container and put it back in place.

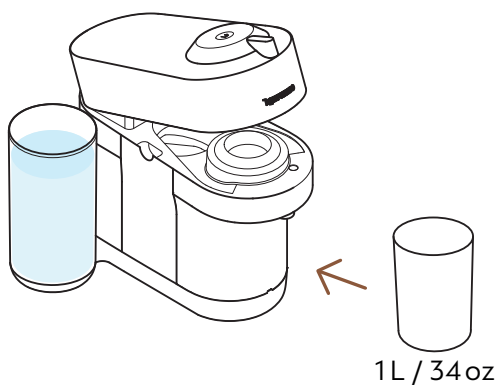

- 4** Remove the cup support and place an empty container (at least 1 L / 34 oz) under the coffee outlet.

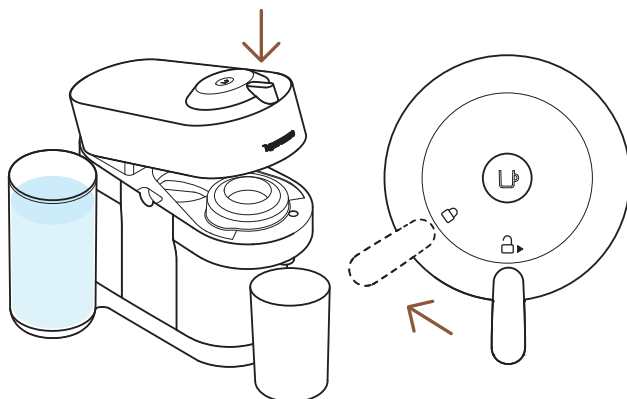

- 5** Close the machine head and turn the lever left towards lock position.

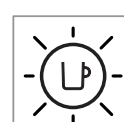
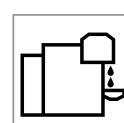
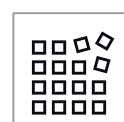
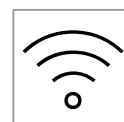
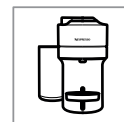

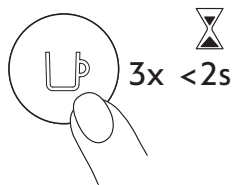

6 With the machine on, press the button 3 times within 2 seconds.

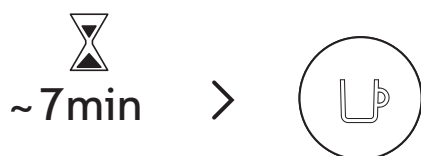

7 The cleaning procedure will run automatically for ~7 minutes. A steady light appears when the cleaning is done.

i It takes ~2 minutes before water begins to flow out of the coffee outlet. The procedure can be stopped at any time by pressing the button.

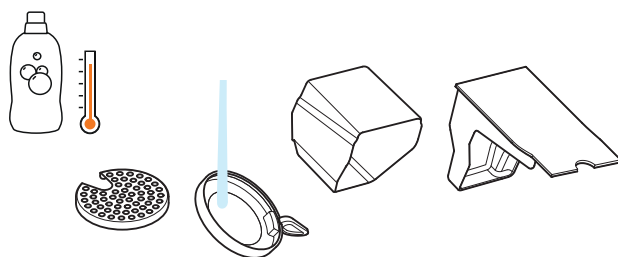

8 Wash the capsule container, the cup support and the drip tray with hot water and mild odourless detergent.

CAUTION: Do not use any strong or abrasive cleaning agent or solvent cleaner. Do not put the machine in a dishwasher. Never immerse the appliance or part of it in water.

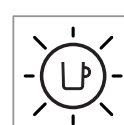
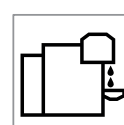
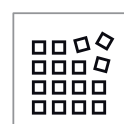
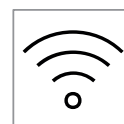
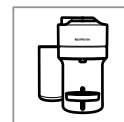

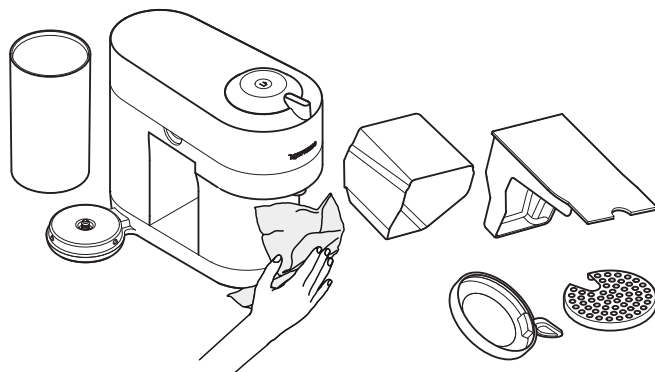

9 Dry the machine with a clean and fresh towel.

CAUTION: Clean the coffee outlet regularly with a clean damp cloth. Always use soft cloths to clean the machine.

NOTE: Water may accumulate inside the machine's head during cleaning. If this happens, please dry visible parts with a clean dry cloth.

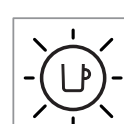
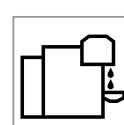
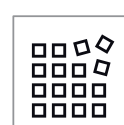
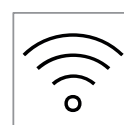
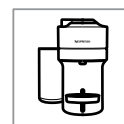

DESCALING

Descaling your machine will ensure that it functions properly throughout its lifetime and will make your coffee experience as incomparable as it was the first day. Your machine will indicate when descaling is needed by blinking orange 3 times before steady white.



i The descaling procedure takes ~20 minutes and cannot be interrupted.

You will need:

- A descaling kit available on www.nespresso.com
- An empty container (1L / 34 oz)

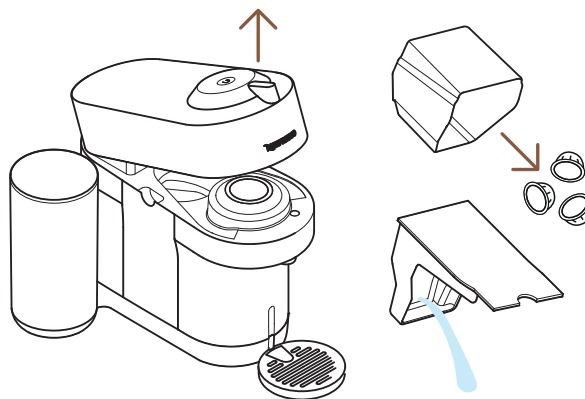

1 Open the machine and let the used capsule be ejected. Empty the capsule container and the drip tray and place them back in position on the machine.

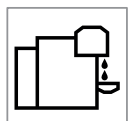
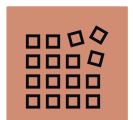

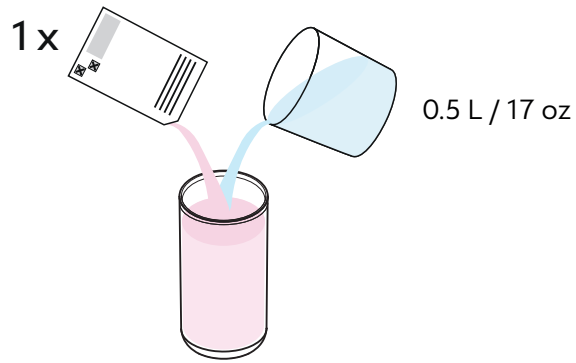

- 2** Fill the water tank with 0.5 L / 17 oz of water and add 1 unit of **Nespresso** descaling liquid.

CAUTION: Please note that the descaling solution can be harmful. Avoid contact with eyes, skin and surfaces.

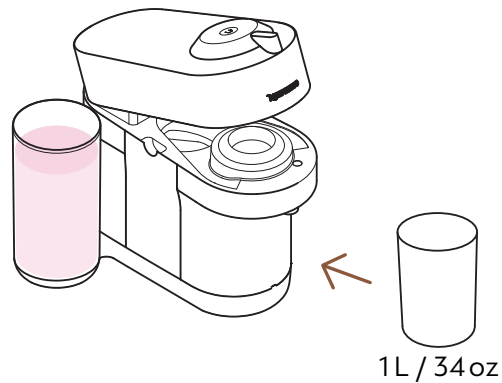

- 3** Remove the cup support and place an empty container (at least 1 L / 34 oz) under the coffee outlet.

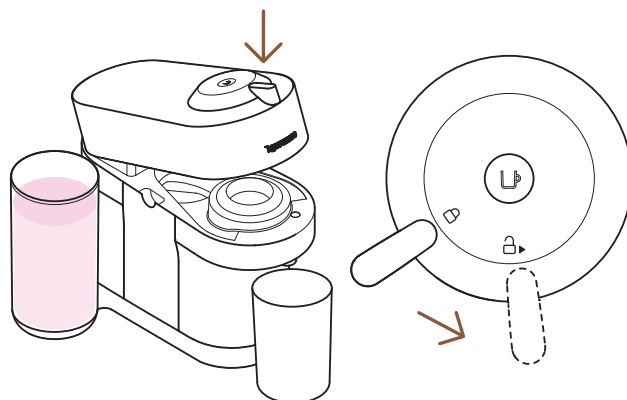

- 4** With machine on, close the machine head and leave the lever in unlock position.

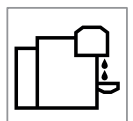
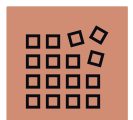

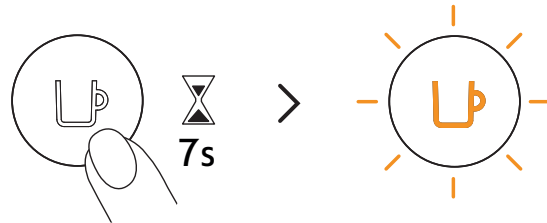

- 5** Hold the button for at least 7 seconds. The button starts blinking orange rapidly.

CAUTION: You now have 45 seconds to enter the descaling mode, otherwise the machine will return to the brewing mode.

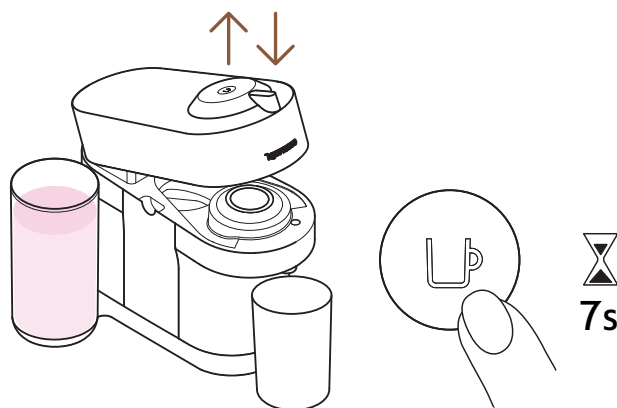

- 6** Open and close the machine head and leave the lever in unlock position. Hold the button again for at least 7 seconds.

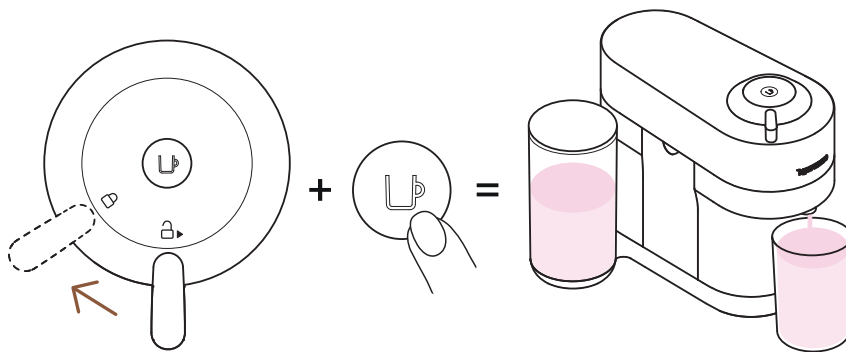

- 7** Turn the lever left towards the lock position and press on the button once.

- i** The machine will stop automatically when the first phase of descaling is completed.

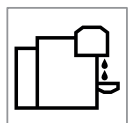
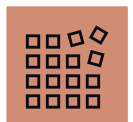

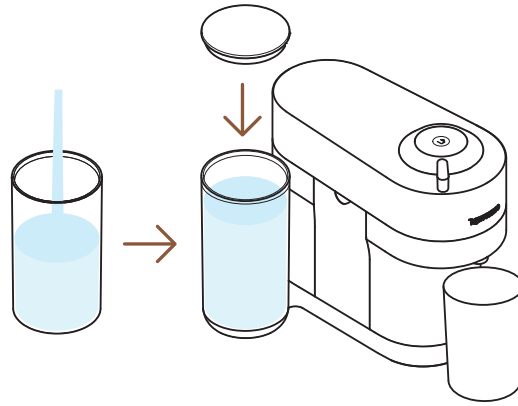

- 8** Now, it's time to rinse the machine. Rinse the water tank and fill it with fresh potable water. Put it back in place.

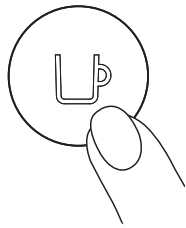

- 9** Push the button to rinse the machine. When the button stops blinking rapidly, the descaling procedure is completed.

- i** The machine will stop automatically when the procedure is completed.

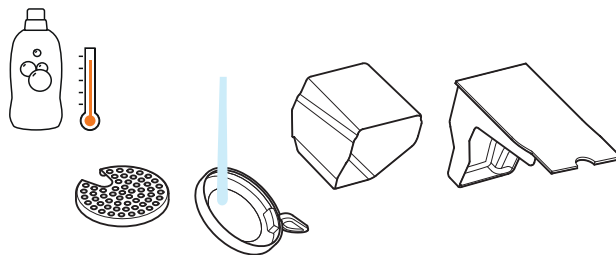

- 10** Wash the capsule container, the cup support and the drip tray with hot water and mild odourless detergent.

CAUTION: Do not use any strong or abrasive cleaning agent or solvent cleaner. Do not put the machine in a dishwasher. Never immerse the appliance or part of it in water.

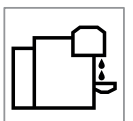
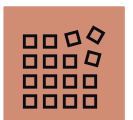

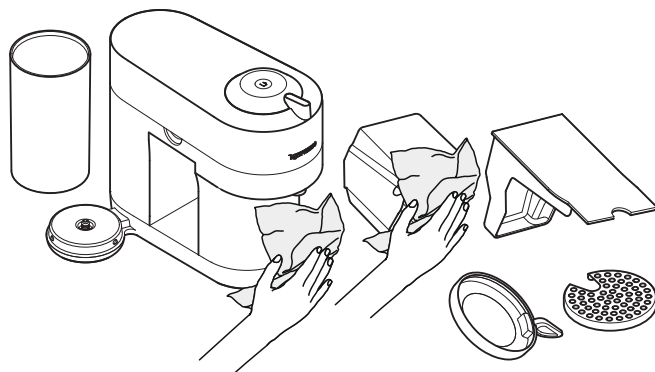

11 Dry the machine with a clean and fresh towel.

CAUTION: Do not use any strong or abrasive cleaning agent or solvent cleaner. Do not put the machine in a dishwasher. Never immerse the appliance or part of it in water.

NOTE: Water may accumulate inside the machine's head during cleaning. If this happens, please dry visible parts with a clean dry cloth.

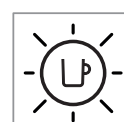
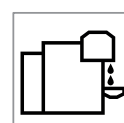
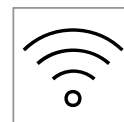
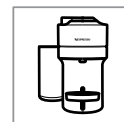

EMPTYING

Emptying the system is a process that could be done before a period of non-use, for frost protection or prior to sending the machine for a repair.

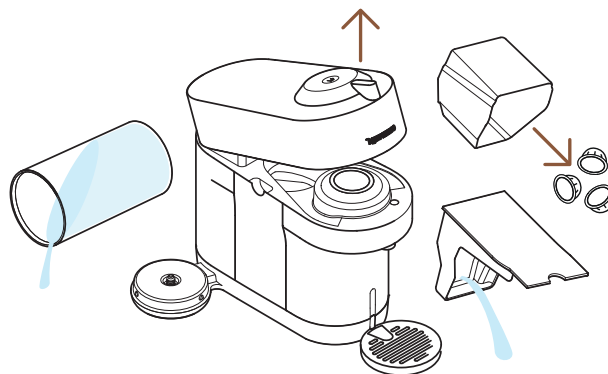

- 1** Empty the water tank, open the machine head, and let the used capsule be ejected. Empty the capsule container and the drip tray.

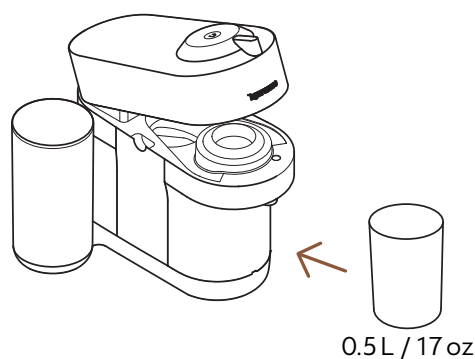

- 2** Place them back in position on the machine, remove the cup support and place an empty container (0.5 L / 17 oz) under the coffee outlet.

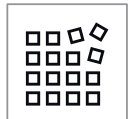

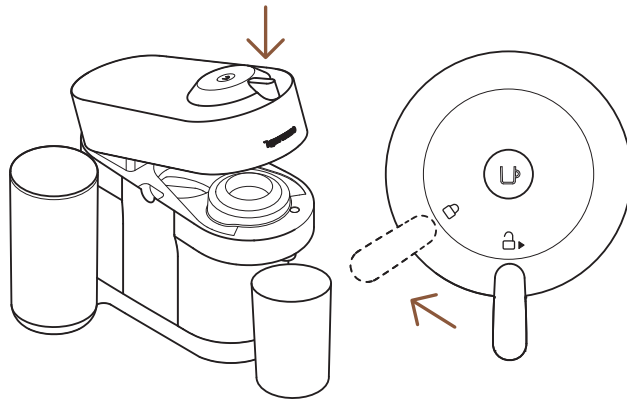

- 3** With machine plugged, open and close the machine head and turn the lever towards the lock position.

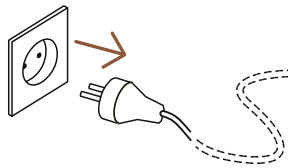

- 4** Unplug the machine.

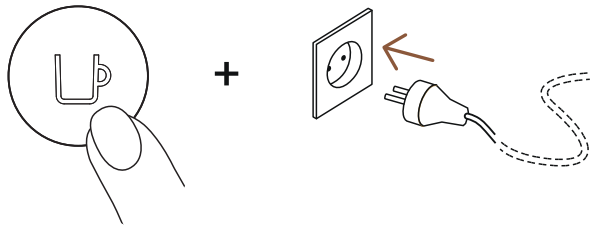

- 5** Press and hold the button while plugging the machine.

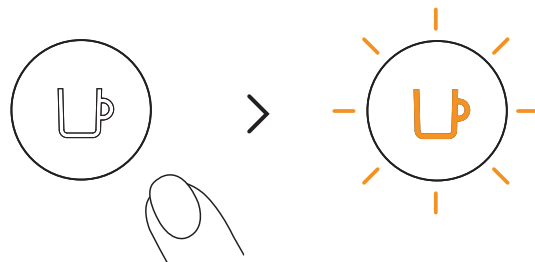

- 6** Release the button. It will blink orange and the emptying process will start.

- i** It will take approximately 30 seconds for the machine to complete the emptying process. The machine turns off automatically when it is empty.



MACHINE SETTINGS



RESET TO FACTORY SETTINGS

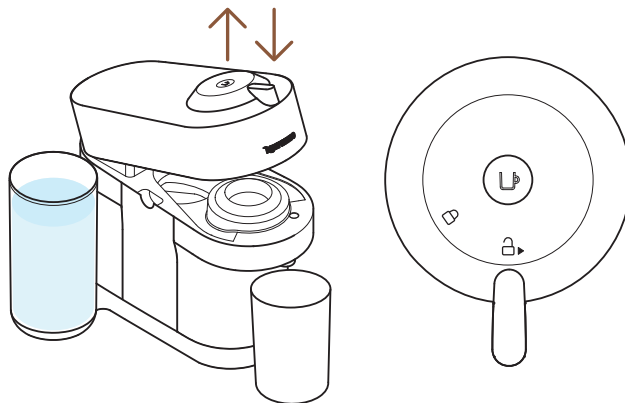

- 1 With the machine plugged, open then close the machine head before leaving the lever on the unlock position.

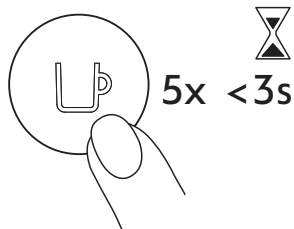

- 2 Press the button 5 times within 3 seconds. The machine is now programmed with the factory settings.



MACHINE BLUETOOTH AND WI-FI

The machine comes with a connectivity module, enabled by default. It gives access to additional features, enhancing your coffee experience. To disable the connectivity module, follow these steps:

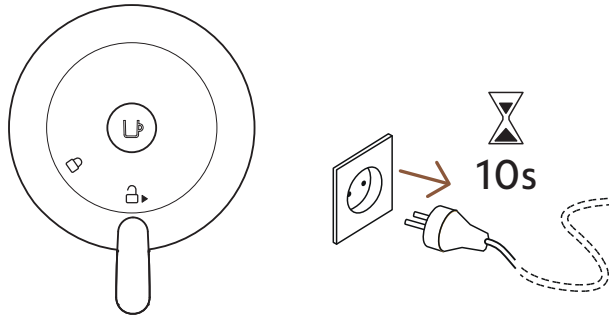

- 1 With the machine closed and the lever in unlocked position, unplug the machine for at least 10 seconds.

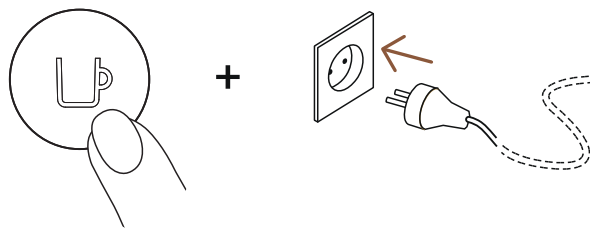

- 2 Press and hold the button whilst plugging the machine. The button will blink orange to confirm that the connectivity module has now been disabled.

- i** Follow the same steps to set the connectivity module back on again. The button will blink white to confirm that the module has been reactivated.



BLINKING SUMMARY

You want to learn more about the Vertuo Pop+ blinkings?
Check out the following video:

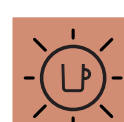
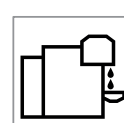
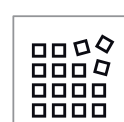
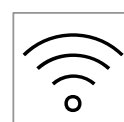
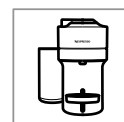

TROUBLESHOOTING

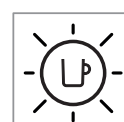
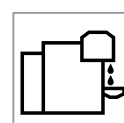
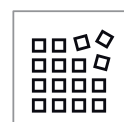
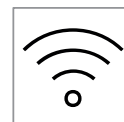
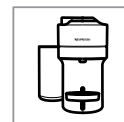

- No light on the button.**
- The machine has turned OFF automatically; push the button or “UNLOCK” the machine.
 - Check the mains, plug, voltage, and fuse.
- No coffee, no water.**
- Check that the water tank is filled.
 - Check that a fresh capsule is inserted in the correct position, that the lever is properly locked and push the button to start.
 - Descale if necessary.
 - Open the machine head and let the capsule be ejected. Then perform a cleaning as per cleaning section.
- Coffee is not hot enough.**
- Preheat the cup with hot drinking water from the tap.
 - Descale if necessary.
- Leakage or unusual coffee flow.**
- Check that the water tank is well positioned.
 - Descale if necessary.
- Machine turns to “OFF mode”.**
- To save energy the machine will turn off after 2 minutes of non-use.
 - The machine can be turned “OFF” manually at any time (when not in use) by pressing and holding the button for 3 seconds.
- Coffee grounds in the cup.**
- Perform the cleaning procedure twice.
 - See paragraph on “Cleaning”.
- The machine doesn't start and has light steady on. If blinking, see next points.**
- Check that the lever is properly locked.
 - If you want to brew a Coffee, check that a fresh capsule is inserted in the correct position, that the lever is properly locked and push the button to start.
 - If you are cleaning, descaling or emptying the system, check that no capsule is inserted then close, lock the machine and push the button to start one of these operations.
- The machine doesn't start and light blinks alternately; 1 blink and 1 pause.**
- Fill the water tank and push the button to start.
 - Check that the lever is properly locked.

Light blinks while machine is running.

- If the coffee is flowing normally, this indicates the machine is working properly.
- If only water is flowing, the machine is executing a user request for either cleaning, descaling or emptying the system. Refer to the corresponding section in this user manual.
- Turn the machine to “OFF mode” by pushing the button for 3 seconds and then push it again to turn the machine ON. Now wait approximately 20 minutes to allow the machine to cool down after extensive use.

Light blinks and machine is not running.

- It will take some time before the coffee flow comes out (due to code reading and pre-wetting the coffee).
- Check that a fresh capsule is inserted in the correct position, that the lever is properly locked and push the button to start.
- Fill the water tank and push the button to start.
- Turn the machine to “OFF mode” by pushing the button for 3 seconds and then push it again to turn the machine ON. Now, wait approximately 20 minutes to allow the machine to cool down after extensive use.

Light blinks alternately 2 blinks and 1 pause continuously. Machine is not running.

- During regular Coffee preparation:
 - 1) Unlock the lever and open the machine head to check that a fresh undamaged capsule is inserted in the correct position.
 - 2) Check that the lever is in “LOCKED” position.
 - 3) Check that the water tank is filled.
- During Descaling, Emptying and Cleaning:
 - 1) Check that the capsule is ejected.
 - 2) Check that the lever is in “LOCKED” position.
- During Programming Volume:
 - 1) Check if a capsule has been well inserted.
 - 2) Please refer to the corresponding chapter.

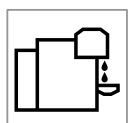

**Light alternately
blinking 3 times and
then steady on.**

- If the problem persists:
 - 1) Unlock the lever and open the machine head.
 - 2) Replace the capsule (if needed).
 - 3) Disconnect the power cord from the outlet and plug the machine back into the outlet after 10 seconds.
 - 4) Close the head and press the button to turn ON and press again to start brewing. If the problem persists, call **Nespresso**.
- Descaling needed: the machine can be used only a few times after the descaling alert appears before it becomes necessary.

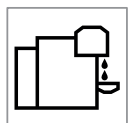

SPECIFICATIONS

Power	US, CA: 120 V, 60 Hz, 1500 W MX: 127 V~, 60 Hz, 1650 W
Frequency	2.402–2.480 GHz
RF output power (EIRP)	Bluetooth 4 dBm Max. e.i.r.p. and Wi-Fi <20 dMm max. e.i.r.p.
Dimensions (W x D x H)	219 x 356 x 265 mm / 8.6 x 14 x 10.4 in
Weight	Vertuo Pop+: 3.6 kg / 7.9 lbs Vertuo Pop+ Deluxe: 3.7 kg / 8.1 lbs
Water tank capacity	Vertuo Pop+: 0.75 L / 25.4 oz Vertuo Pop+ Deluxe: 1.1 L / 37.2 oz
Capsule container capacity	8 espresso or 5 mug capsules

MACHINE CODES

Nespresso	Breville	Delonghi
GCV6 GDV6	BNV520, BNV550, BNV530, BNV560, BNV540, BNV570	ENV92B, ENV92BAE, ENV92Y, ENV92YAE, ENV92AAE, ENV95S, ENV95SAE

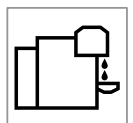

CLIQUEZ POUR SÉLECTIONNER VOTRE LANGUE

EN

FR

ES



MESURES DE SÉCURITÉ



VUE D'ENSEMBLE



CONNECTIVITÉ



PREMIÈRE UTILISATION



PRÉPARATION DU CAFÉ



ADAPTER LE VOLUME DE VOTRE CAFÉ



NETTOYAGE



DÉTARTRAGE



VIDAGE



RÉGLAGES DE LA MACHINE



RÉSUMÉ DES CLIGNOTEMENTS



DÉPANNAGE



SPÉCIFICATIONS

MESURES DE SÉCURITÉ

ATTENTION : Avant d'utiliser votre machine à café, veuillez vous référer à la notice d'instructions de sécurité afin d'éviter tout risque de blessure ou de dommage.

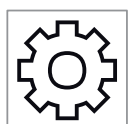
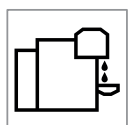
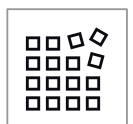

VUE D'ENSEMBLE

APERÇU DE LA MACHINE

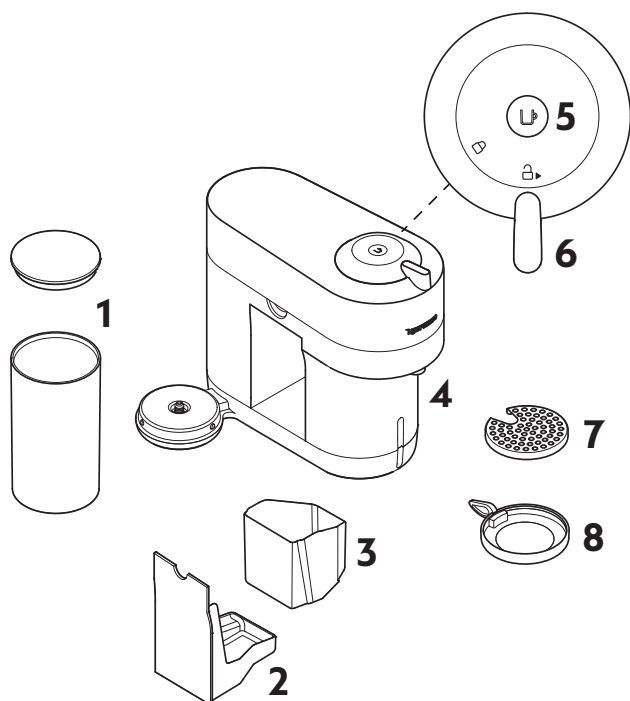

- 1 Réservoir d'eau et couvercle
- 2 Bac d'égouttage
- 3 Collecteur de capsules usagées
- 4 Orifice de sortie du café
- 5 Bouton café et MARCHÉ/ARRÊT
- 6 Poignée de verrouillage/déverrouillage
- 7 Grille d'égouttage
- 8 Support de tasse réglable

CONTENU DE L'EMBALLAGE



- 1 Machine à café
- 2 Ensemble de capsules **Nespresso**
- 3 Kit **Nespresso** de bienvenue
- 4 Consignes de sécurité
- 5 Guide de démarrage rapide
- 6 Garantie

i Déballage : de la poussière peut être présente à la surface de la machine à cause des matériaux recyclés utilisés dans l'emballage. Ce n'est pas dangereux, il suffit de nettoyer avec un chiffon doux.

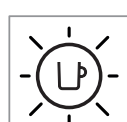
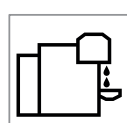
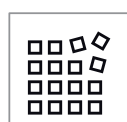
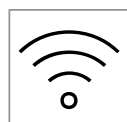

OUVERTURE / FERMETURE

OUVERTURE

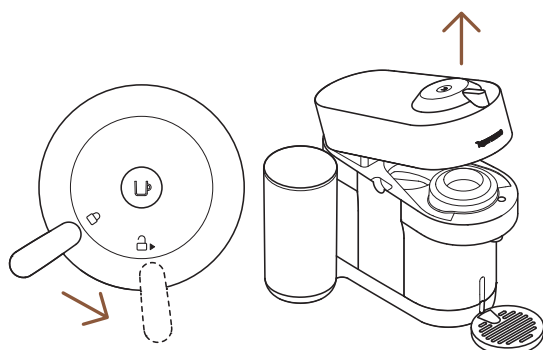

FERMETURE

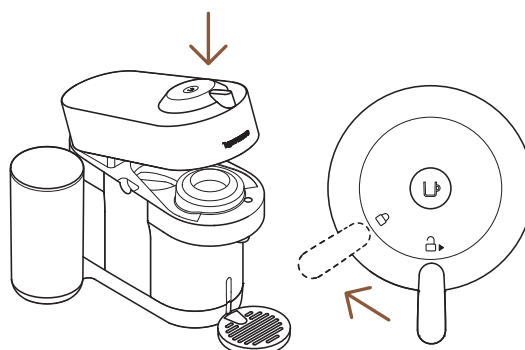

LE SYSTÈME VERTUO

CAPSULES DISPONIBLES



P

Espresso

(40 ml / 1,4 oz liq)



M

Double Espresso

(80 ml / 2,8 oz liq)

Gran Lungo

(150 ml / 5,1 oz liq)



G

Tasse

(230 ml / 7,8 oz liq)



TG

**Alto, Café infusé
à froid**

(355 ml / 12,5 oz liq)

Carafe

(535 ml / 18,8 oz liq)

ACCESSOIRES



Accessoires
adaptés



Espresso



**Double
Espresso**



Gran Lungo



Tasse



Verre Reveal



Accessoires
non adaptés



Alto



Carafe

Découvrez notre collection complète d'accessoires sur
www.nespresso.com

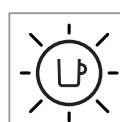
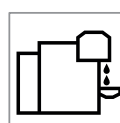
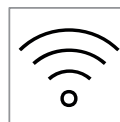

CONNECTIVITÉ

POURQUOI JUMELER VOTRE MACHINE VERTUO POP+ ?

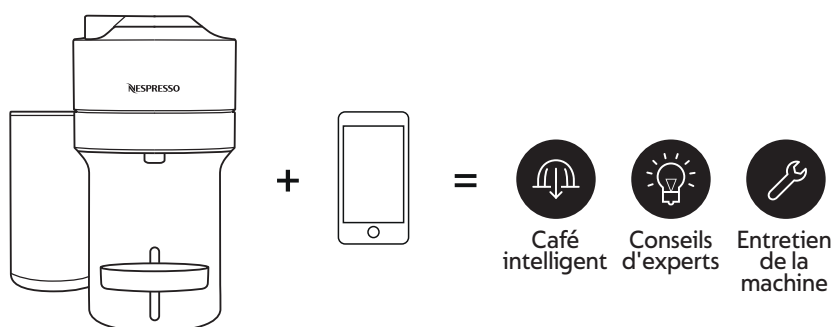

LES AVANTAGES DE CONNECTER VOTRE MACHINE VERTUO POP+

- **Café intelligent :** Profitez des dernières innovations de **Nespresso** en matière de café en maintenant toujours votre machine à jour.
- **Conseils d'experts :** Recevez des conseils en temps réel avec des instructions étape par étape pour détartrer, rincer et nettoyer votre machine.
- **Entretien de la machine :** Obtenez une assistance et des tutoriels pour l'entretien de votre machine via votre téléphone intelligent.

COMMENT CONNECTER VOTRE MACHINE VERTUO POP+ ?

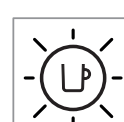
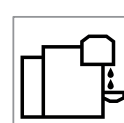
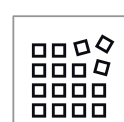
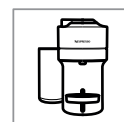



1 Téléchargez ou mettez à jour l'application **Nespresso**.

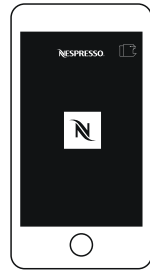

2 Lancez l'application sur votre appareil mobile ou tablette.

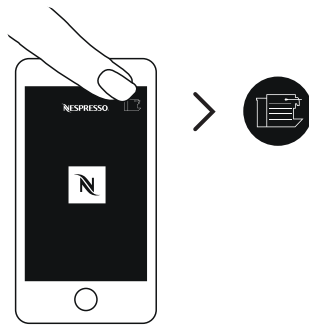

3 Cliquez sur l'icône machine en haut à droite de votre écran.

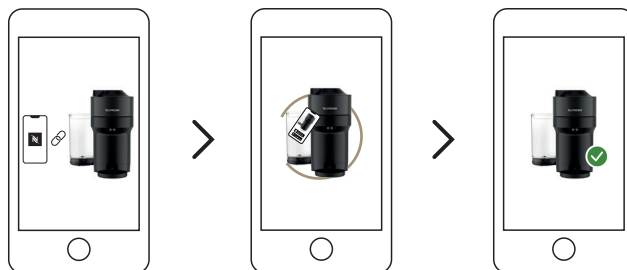

4 Suivez les instructions via l'application **Nespresso**.

* AppStore® est une marque d'Apple Inc. déposée aux États-Unis et dans d'autres pays.

** Google Play et le logo Google Play sont des marques déposées de Google LLC.

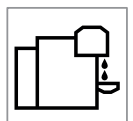
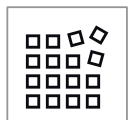

PREMIÈRE UTILISATION

MARCHE / ARRÊT

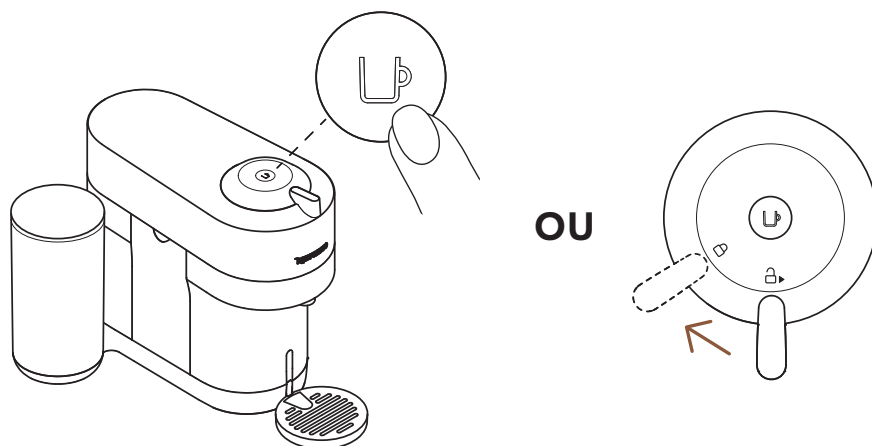

MARCHE

Une fois la machine branchée, mettez-la en marche en appuyant une fois sur le bouton ou en fermant le levier en position de verrouillage (avec la tête fermée).

- i** La lumière clignotera pendant environ 30 secondes pendant que la machine chauffe. Lorsque le voyant est allumé, la machine est prête.



ARRÊT

Pour économiser de l'énergie, la machine s'éteindra automatiquement après 2 minutes de non-utilisation.

- i** La machine peut être éteinte manuellement à tout moment (lorsqu'elle n'est pas utilisée) en appuyant sur le bouton et en le maintenant enfoncé pendant 3 secondes.

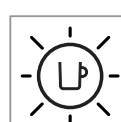
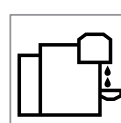
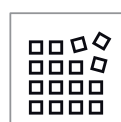
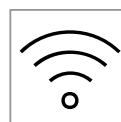
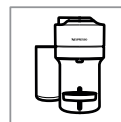

PREMIER RINÇAGE

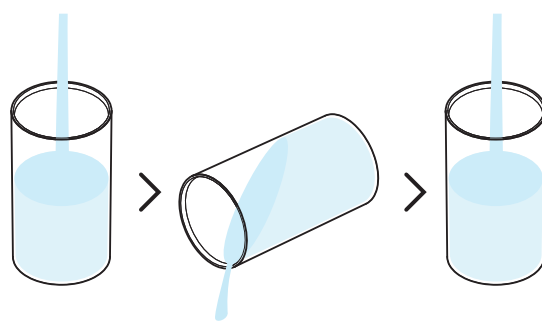

- 1** Rincer le réservoir d'eau et le remplir d'eau potable fraîche.

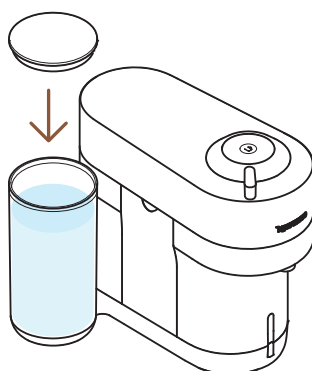

- 2** Fermez le réservoir d'eau avec le couvercle et remettez le réservoir d'eau en place sur la machine.

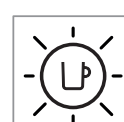
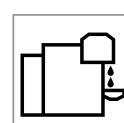
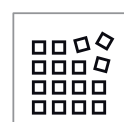
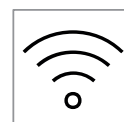
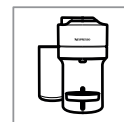

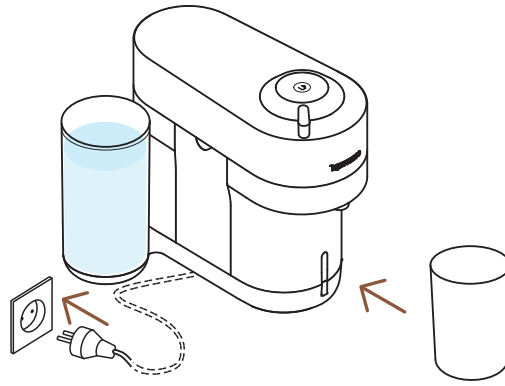

- 3** Branchez le cordon d'alimentation, retirez le support de tasse et placez un récipient vide (au moins 1 L / 34 oz liq) sous la sortie du café.

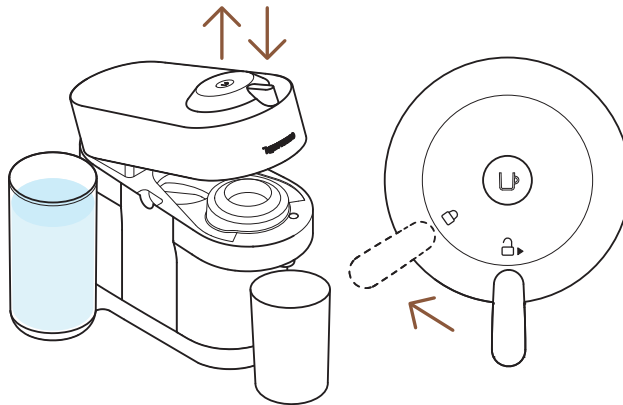

- 4** Ouvrir et fermer la machine. S'assurer que le levier est en position de verrouillage.

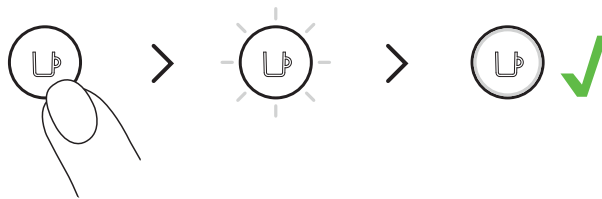

- 5** Mettez la machine en marche en cliquant une fois sur le bouton.

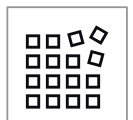

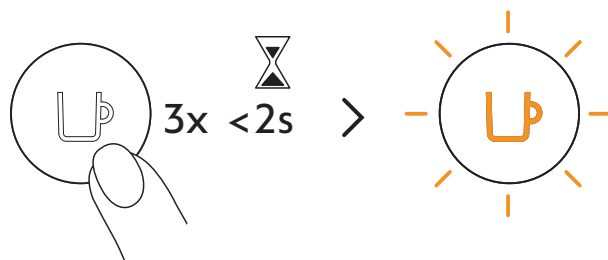

6 Appuyez sur le bouton 3 fois en moins de 2 secondes.

i La machine commencera à rincer. Cette procédure peut prendre jusqu'à 7 minutes.

ATTENTION : Lisez d'abord les consignes de sécurité pour éviter les risques de choc électrique mortel et d'incendie. Veuillez assurer la continuité de la mise à la terre lorsque vous branchez la machine sur la prise de courant.

i Lors du déballage de la machine, retirez les films plastiques.

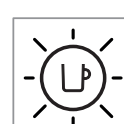
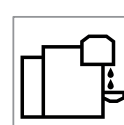
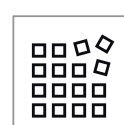
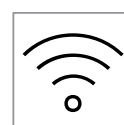
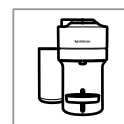

PRÉPARATION CAFÉ

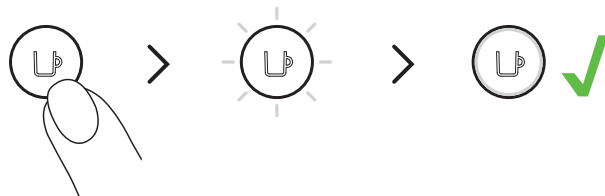

- 1** Mettez votre machine en marche en cliquant une fois sur le bouton ou en fermant le levier vers la position de verrouillage.

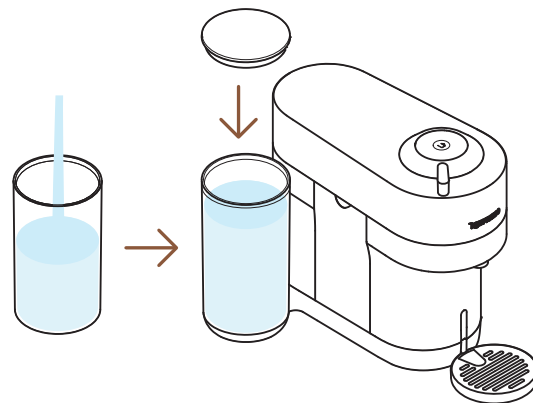

- 2** Remplir le réservoir avec de l'eau potable fraîche et le mettre en place.

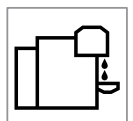
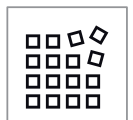

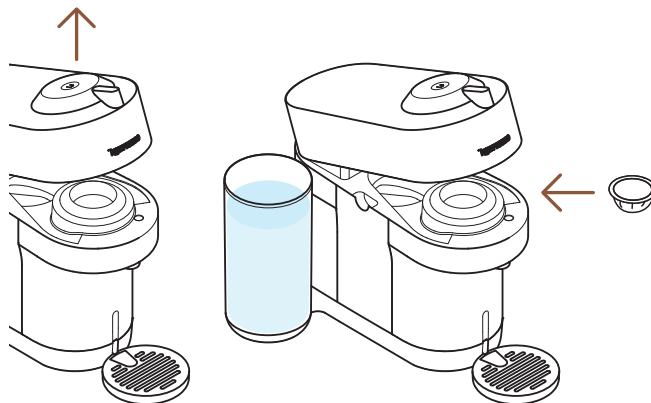

- 3** Ouvrez la machine et insérez une capsule Vertuo.

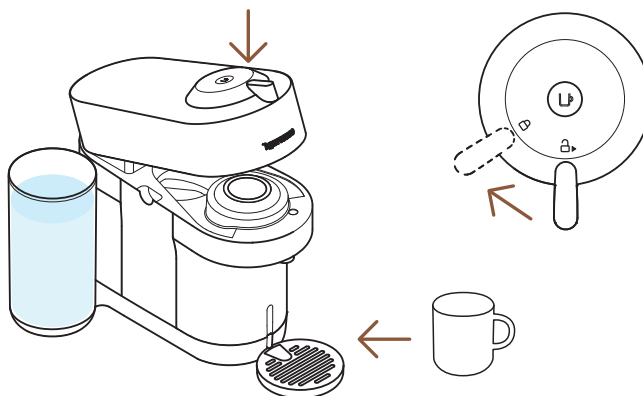

- 4** Fermez la machine en tournant le levier jusqu'à la position de verrouillage et placez une tasse. Le support de tasse peut être réglé pour s'adapter à votre taille de tasse.

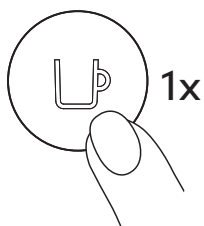

- 5** Commencez l'infusion en cliquant une fois sur le bouton.

NOTE : de l'eau peut s'accumuler à l'intérieur de la tête de la machine, veuillez sécher les parties visibles avec un chiffon propre et sec.

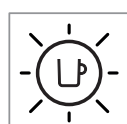
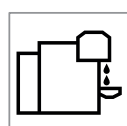
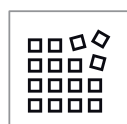
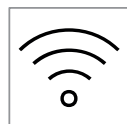

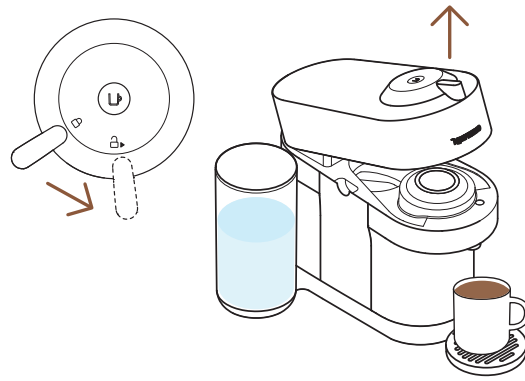

- 6** Lorsque le café ne coule plus, ouvrez la machine en tournant le levier vers la position de déverrouillage, éjectez la capsule et savourez votre café.

DÉCOUVREZ NOTRE EXTRACTION CONCENTRÉE POUR LES RECETTES BARISTA

Avec cette machine, **Nespresso** vous propose une fonction spécifique pour concentrer vos extractions de café afin de créer vos propres recettes.

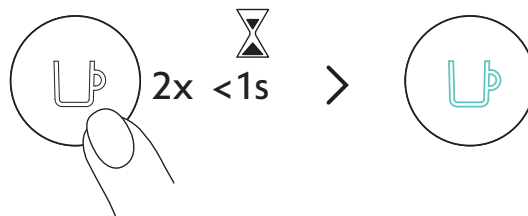

Une fois votre machine allumée, cliquez rapidement 2 fois sur le bouton café, il clignotera en turquoise et votre café sera concentré, améliorant le goût du café dans les recettes avec ajouts (crème, sur glace...).

40 ml / 1.4 oz liq	80 ml / 2.7 oz liq	150 ml / 5.1 oz liq	230 ml / 7.8 oz liq	
∨	∨	∨	∨	
25 ml / 0.85 oz liq	40 ml / 1.4 oz liq	40 ml / 1.4 oz liq	80 ml / 2.7 oz liq	



Découvrez comment perfectionner votre machine avec notre gamme Aeroccino sur www.nespresso.com

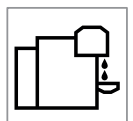
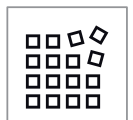

ADAPTER LES VOLUMES DE CAFÉ

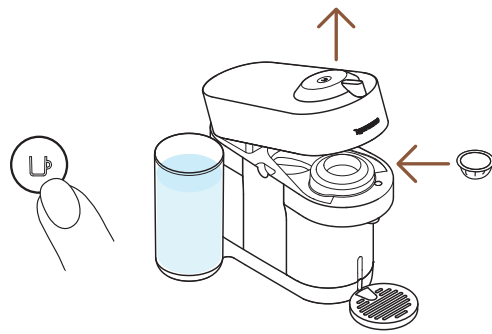

- 1 Allumez la machine en cliquant une fois sur le bouton, ouvrez la machine et insérez la capsule que vous voulez infuser.

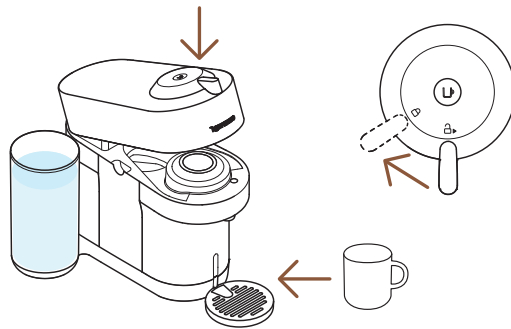

- 2 Fermez la machine, tournez le levier vers la position de verrouillage et placez une tasse.

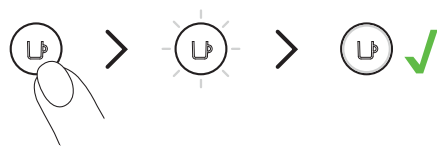

- 3 Appuyez sur le bouton et maintenez-le enfoncé jusqu'à ce que le volume souhaité soit atteint. Le nouveau volume d'eau est maintenant programmé pour le type de capsule utilisé lors du réglage.

i La programmation est spécifique à chaque type de capsule. Les tailles de tasses peuvent être programmées de 20 ml / 0,7 oz à 535 ml / 18 oz.

REMARQUE : Une fois qu'un volume spécifique au client est programmé par l'utilisateur, chaque fois que ce type de capsule est inséré dans la machine, la préparation s'arrêtera à la taille de tasse programmée par l'utilisateur. Si vous souhaitez revenir aux paramètres par défaut, consultez le paragraphe « **Réinitialisation aux paramètres d'usine** ».



NETTOYAGE

Nettoyez votre machine tous les mois, lorsque vous commencez à avoir des résidus de café à l'intérieur de la tête de la machine ou après une longue période de non-utilisation.

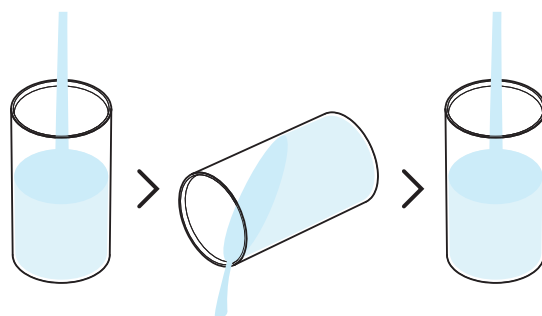

- 1** Rincer et nettoyer le réservoir et le couvercle avec de l'eau potable.

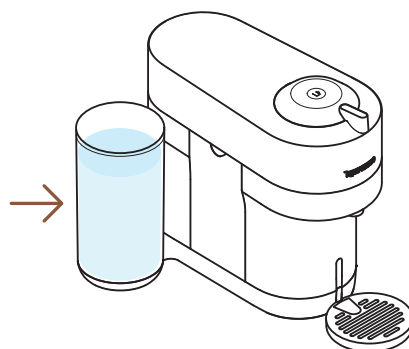

- 2** Remettre le réservoir en place.

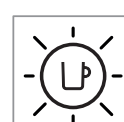
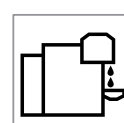
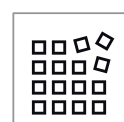
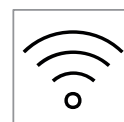
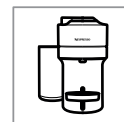

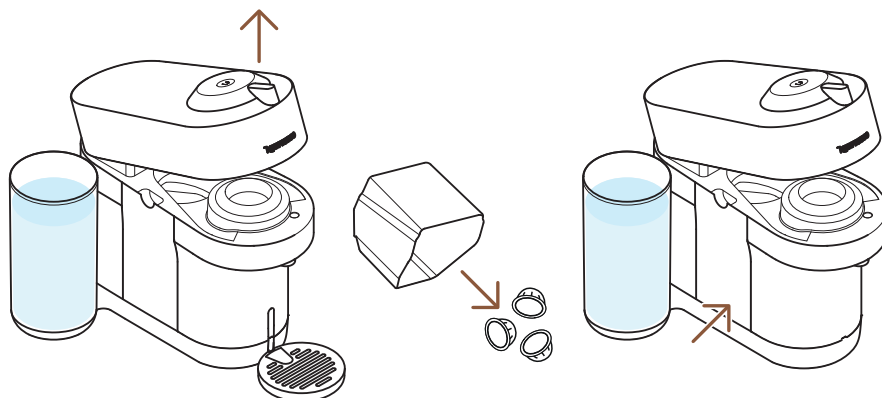

- 3** Ouvrez la machine et laissez la capsule usagée être éjectée. Videz le conteneur à capsules et remettez-le en place.

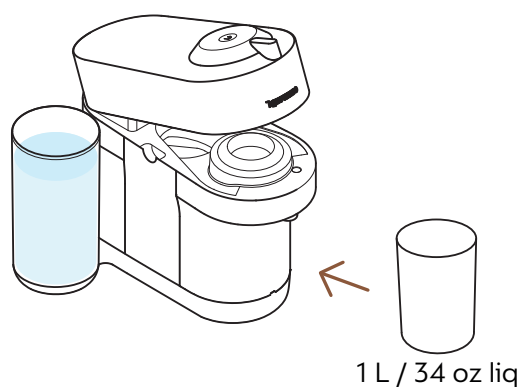

- 4** Retirer le support de tasse. Placer un récipient d'au moins 1 L / 34 fl oz liq. sous l'orifice de sortie du café.

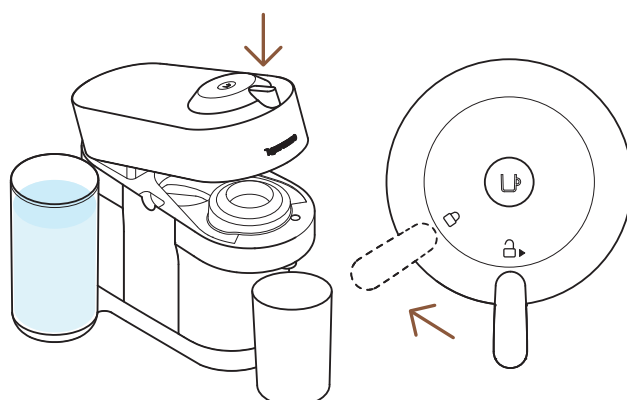

- 5** Fermer la machine et tourner la poignée jusqu'à la position « VERROUILLÉE ».

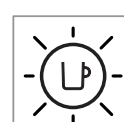
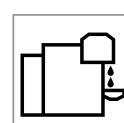
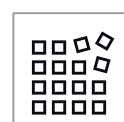
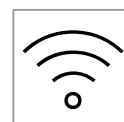
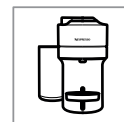

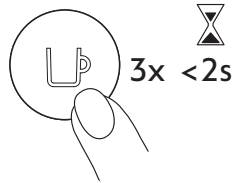

- 6** Lorsque la machine est allumée, appuyez sur le bouton 3 fois en 2 secondes.

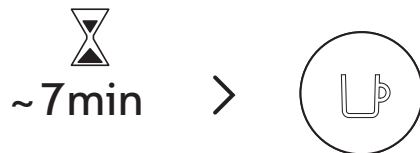

- 7** La procédure de nettoyage se met automatiquement en marche pour une durée de 7 minutes. Une lumière fixe apparaît lorsque le nettoyage est terminé.
- i** Il faut environ 2 minutes pour que l'eau commence à s'écouler de la sortie du café. La procédure peut être arrêtée à tout moment en appuyant sur le bouton.

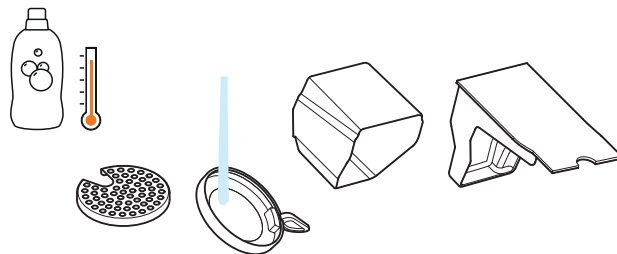

- 8** Lavez le contenant de la capsule, le support de la tasse et le plateau d'égouttage à l'eau chaude et avec un détergent doux et inodore.

ATTENTION : ne pas utiliser de solvants ou de produits nettoyants puissants ou abrasifs. Ne pas mettre au lave-vaisselle. Ne jamais immerger la machine ou ses pièces dans l'eau.



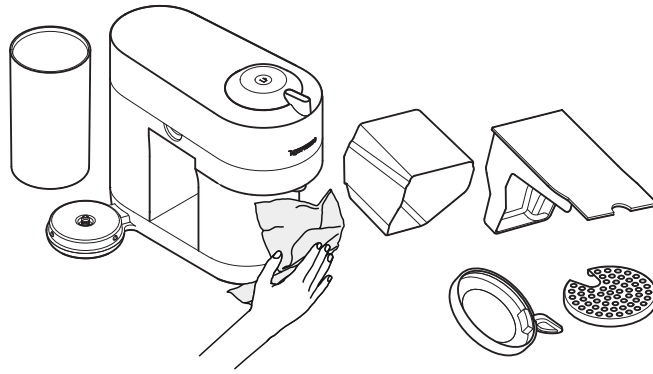

9 Séchez la machine avec une serviette propre et fraîche.

ATTENTION : Nettoyez régulièrement l'orifice de sortie du café à l'aide d'un linge propre et humide. Utilisez toujours des linges doux pour nettoyer la machine.

NOTE : De l'eau peut s'accumuler à l'intérieur de la tête de la machine pendant le nettoyage. Si cela se produit, veuillez sécher les parties visibles avec un chiffon propre et sec.

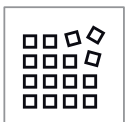

DÉTARTRAGE

Le détartrage de votre machine garantira son bon fonctionnement tout au long de sa durée de vie et rendra votre expérience du café aussi incomparable que le premier jour. Votre machine vous indiquera qu'un détartrage est nécessaire en clignotant 3 fois en orange avant de redevenir blanche.



i La procédure de détartrage dure environ 20 minutes et ne peut pas être interrompue.

Vous aurez besoin :

- Un kit de détartrage disponible sur www.nespresso.com
- Un récipient vide (1L / 34 oz liq)

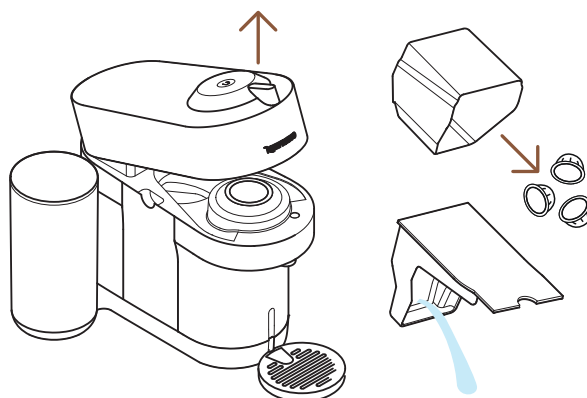

1 Ouvrez la machine et laissez la capsule usagée être éjectée. Videz le conteneur de la capsule et le bac de récupération et remettez-les en place sur la machine.

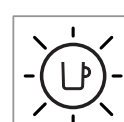
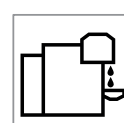
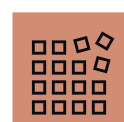
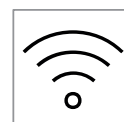
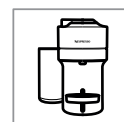

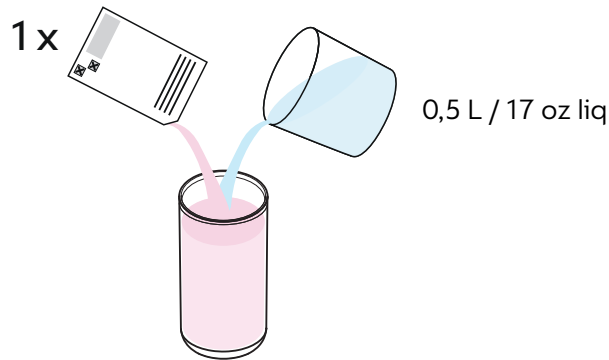

- 2** Mettre 0,5 L / 17 oz liq. d'eau dans le réservoir et ajouter la solution détartrante **Nespresso**.

ATTENTION : la solution détartrante peut être nocive. Éviter tout contact avec les yeux, la peau et les surfaces.

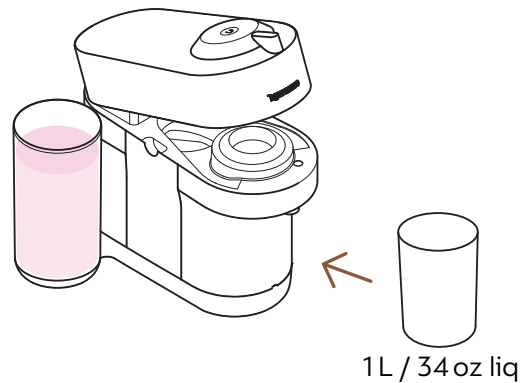

- 3** Retirez le support de tasse et placez un récipient vide (au moins 1 L / 34 oz liq) sous la sortie du café.

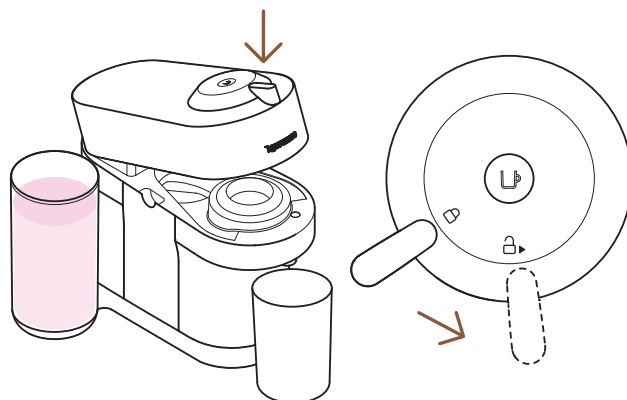

- 4** Lorsque la machine est en marche, fermez la tête de la machine et laissez le levier en position de déverrouillage.

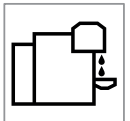

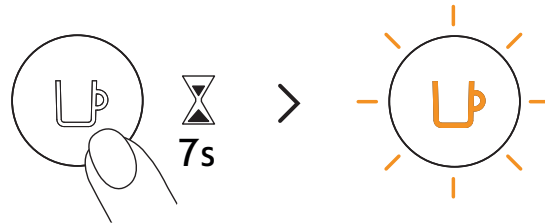

- 5** Maintenez le bouton enfoncé pendant au moins 7 secondes. Le bouton commencera à clignoter orange rapidement.

ATTENTION : Vous avez maintenant 45 secondes pour passer en mode de détartrage, sinon la machine repasse en mode «Prêt à infuser du café».

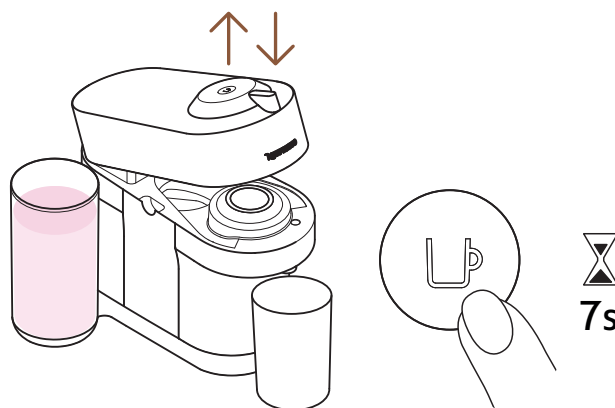

- 6** Ouvrez et fermez la tête de la machine et laissez le levier en position déverrouillée. Maintenez à nouveau le bouton pendant au moins 7 secondes.

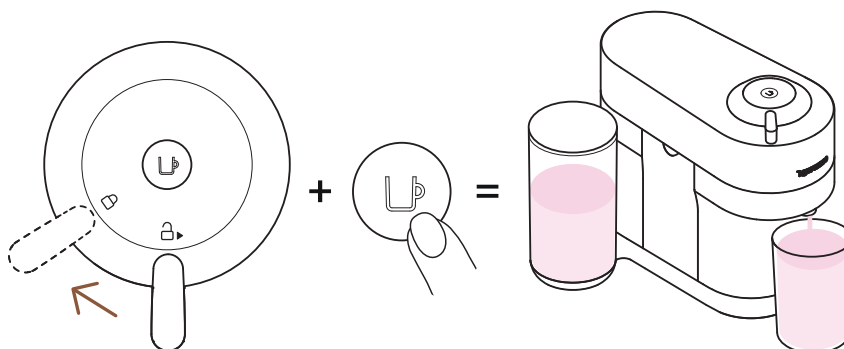

- 7** Tournez le levier vers la gauche en position de verrouillage et appuyez une fois sur le bouton.

- i** La machine s'arrête automatiquement lorsque la première phase de détartrage est terminée.

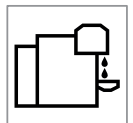

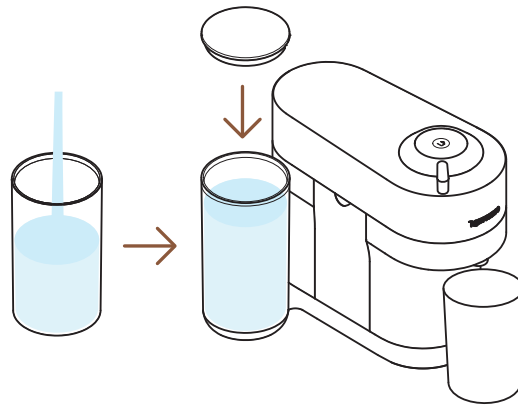

- 8** Maintenant, il est temps de rincer la machine. Rincez le réservoir d'eau et remplissez-le d'eau potable fraîche. Remettez-le en place.

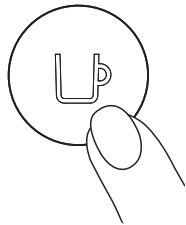

- 9** Appuyez sur le bouton pour rincer la machine. Lorsque le bouton cesse de clignoter rapidement, la procédure de détartrage est terminée.

- i** La machine s'arrête automatiquement lorsque la procédure est terminée.

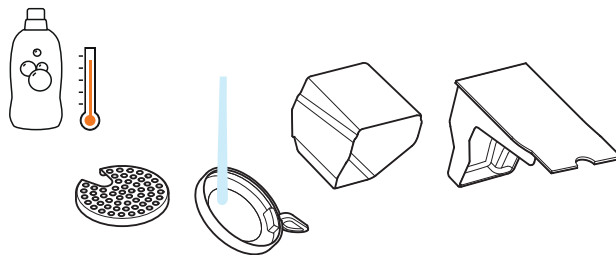

- 10** Lavez le contenant de la capsule, le support de la tasse et le plateau d'égouttage à l'eau chaude et avec un détergent doux et inodore.

ATTENTION : ne pas utiliser de solvants ou de produits nettoyants puissants ou abrasifs. Ne pas mettre au lave-vaisselle. Ne jamais immerger la machine ou ses pièces dans l'eau.

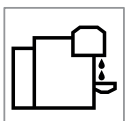

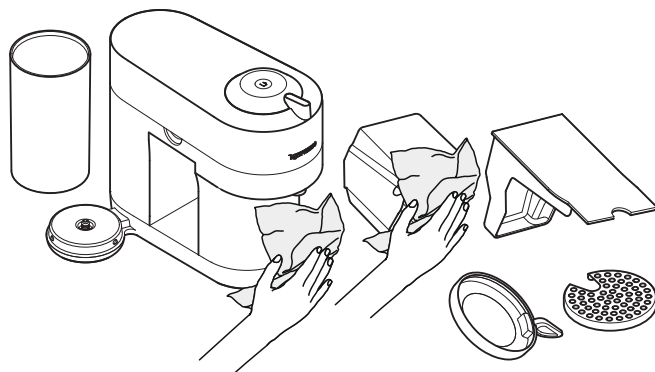

11 Séchez la machine avec une serviette propre et fraîche.

ATTENTION : ne pas utiliser de solvants ou de produits nettoyants puissants ou abrasifs. Ne pas mettre au lave-vaisselle. Ne jamais immerger la machine ou ses pièces dans l'eau.

NOTE : L'eau peut s'accumuler à l'intérieur de la tête de la machine pendant le nettoyage. Si cela se produit, essuyez les parties visibles avec un chiffon propre et sec.

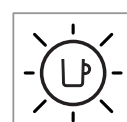
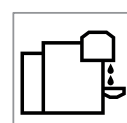
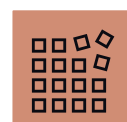
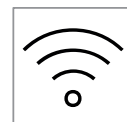
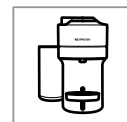

VIDAGE

La vidange du système peut être effectuée avant une période de non-utilisation, pour la protection contre le gel ou avant d'envoyer la machine en réparation.

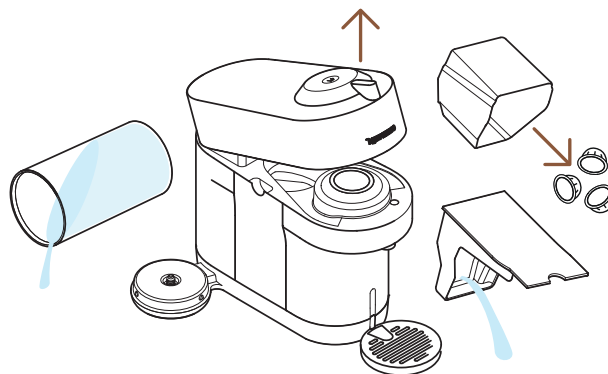

- 1** Videz le réservoir d'eau, ouvrez la tête de la machine et laissez la capsule usagée être éjectée. Videz le récipient à capsules et le bac de récupération.

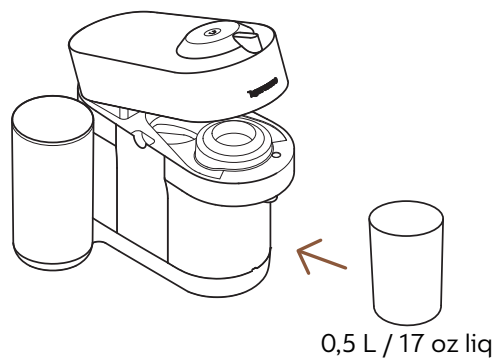

- 2** Remettez-les en place sur la machine, retirez le support de tasse et placez un récipient vide (0,5 L / 17 oz liq) sous la sortie du café.



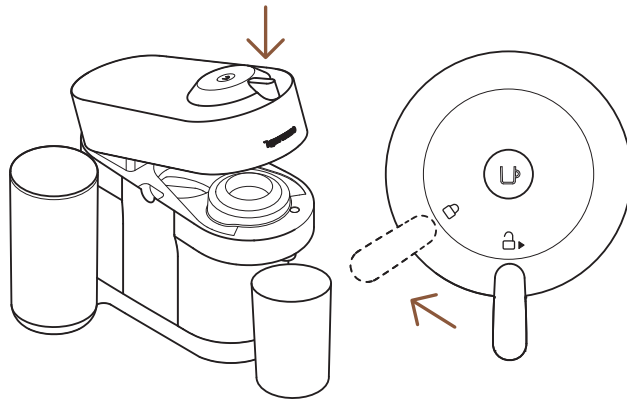

- 3** La machine étant branchée, ouvrez et fermez la tête de la machine et tournez le levier vers la position de verrouillage.

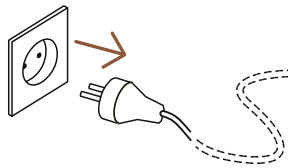

- 4** Débranchez la machine.

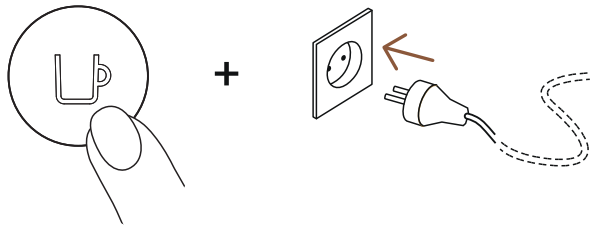

- 5** Appuyez sur le bouton et maintenez-le enfoncé tout en branchant la machine.

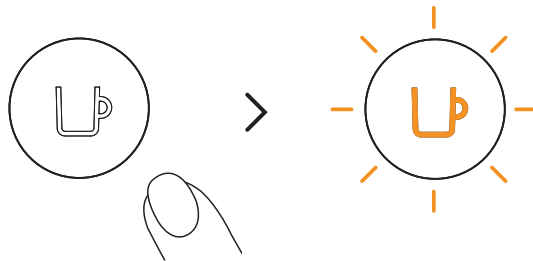

- 6** Relâchez le bouton. Il clignotera en orange et le processus de vidange commencera.

- i** Il faut environ 30 secondes à la machine pour effectuer le processus de vidange. La machine s'éteint automatiquement lorsqu'elle est vide.

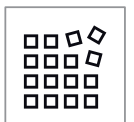

RÉGLAGES DE LA MACHINE



RÉINITIALISATION AUX PARAMÈTRES D'USINE

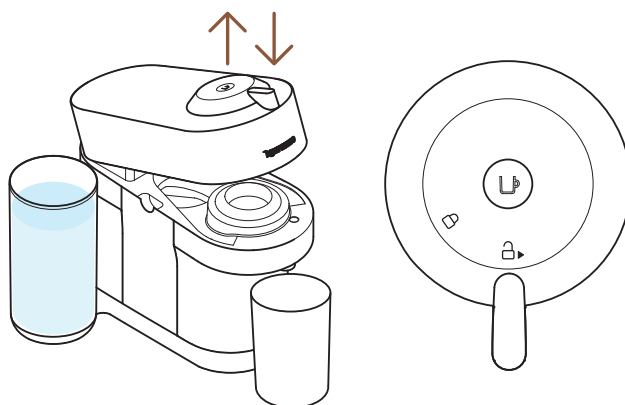

- 1 Lorsque la machine est branchée, ouvrez puis fermez la tête de la machine avant de laisser le levier en position de déverrouillage.

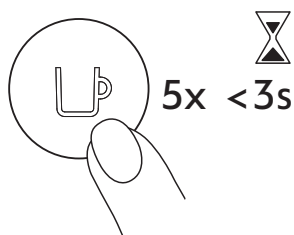

- 2 Appuyez sur le bouton 5 fois dans les 3 secondes. La machine est maintenant programmée avec les réglages d'usine.

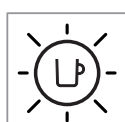
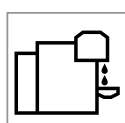
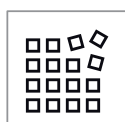
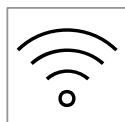

BLUETOOTH ET WI-FI DE LA MACHINE

La machine est dotée d'un module de connectivité, activé par défaut. Il permet d'accéder à des fonctions supplémentaires qui améliorent votre expérience du café. Pour désactiver le module de connectivité, procédez comme suit :

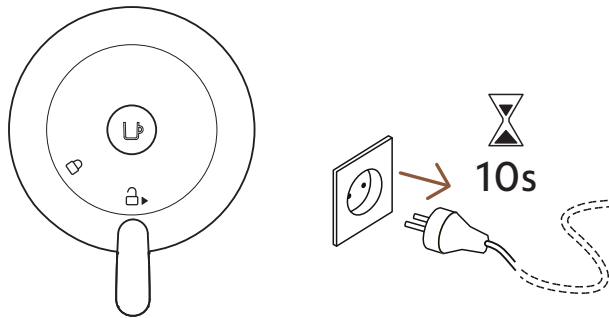

- 1** Avec la machine fermée et le levier en position déverrouillée, débranchez la machine pendant au moins 10 secondes.

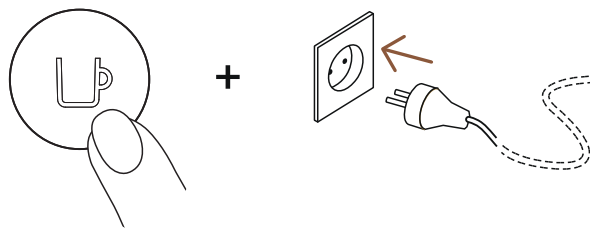

- 2** Appuyez sur le bouton et maintenez-le enfoncé tout en branchant la machine. Le bouton clignotera en orange pour confirmer que le module de connectivité est maintenant désactivé.

- i** Suivez les mêmes étapes pour remettre le module de connectivité en marche. Le bouton clignotera en blanc pour confirmer que le module a été réactivé.

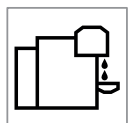
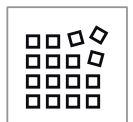

RÉSUMÉ DES CLIGNOTEMENTS

Vous voulez en savoir plus sur les clignotements du Vertuo Pop+ ?
Regardez la vidéo suivante :

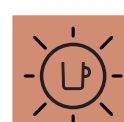
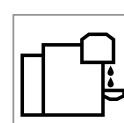
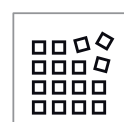
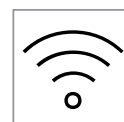
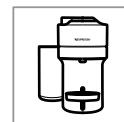

DÉPANNAGE

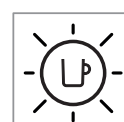
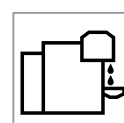
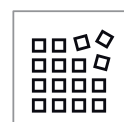
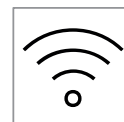
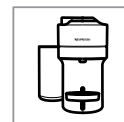

Bouton éteint.

- La machine s'est éteinte automatiquement ; appuyez sur le bouton ou « déverrouillez » la machine.
- Vérifiez le secteur, la prise, la tension et le fusible.

Pas de café, pas d'eau.

- Vérifiez que le réservoir d'eau est rempli.
- Vérifiez qu'une capsule fraîche est insérée dans la bonne position, que le levier est correctement verrouillé et appuyez sur le bouton pour démarrer.
- Détartrez si nécessaire.
- Ouvrez la tête de la machine et laissez la capsule être éjectée. Effectuez ensuite un nettoyage comme indiqué dans la section nettoyage.

Le café n'est pas assez chaud.

- Préchauffer la tasse avec de l'eau chaude du robinet.
- Détartrez si nécessaire.

Il y a une fuite ou le café s'écoule de façon inhabituelle.

- Vérifier si le réservoir d'eau est correctement positionné.
- Détartrez si nécessaire.

La machine s'éteint automatiquement.

- Pour économiser de l'énergie, la machine s'éteint automatiquement après 2 minutes d'inutilisation.
- La machine peut être éteinte manuellement à tout moment (lorsqu'elle n'est pas utilisée) en appuyant sur le bouton et en le maintenant enfoncé pendant 3 secondes.

Des résidus de café présents dans la tasse.

- Lancer la procédure de nettoyage deux fois de suite.
- Voir la section intitulée « Nettoyage ».

La machine ne fonctionne pas et le voyant est allumé en continu sur «marche». Si le voyant clignote, voir les points suivants.

- Vérifier si la poignée est adéquatement verrouillée.
- Pour préparer un Café ou un Espresso, vérifier si la capsule est neuve et correctement insérée, et si la poignée est adéquatement verrouillée, puis appuyer sur le bouton.

La machine ne fonctionne pas et le voyant clignote de façon intermittente (un clignotement, puis une pause).

Le voyant clignote pendant que la machine fonctionne.

Le voyant clignote alors que la machine ne fonctionne pas.

- Pour la procédure de nettoyage, de détartrage ou de vidange, vérifier que le compartiment de capsules est bel et bien vide, fermer et verrouiller la machine, puis appuyer sur le bouton pour lancer la procédure voulue
- Remplir le réservoir d'eau, puis appuyer sur le bouton.
- Vérifier si la poignée est adéquatement verrouillée.
- Si le café coule normalement, la machine fonctionne bien.
- Si la machine n'expulse que de l'eau, elle effectue un nettoyage, un détartrage ou une vidange, selon la demande de l'utilisateur. Se référer au chapitre correspondant dans ce manuel d'utilisation.
- Mettez la machine en mode arrêt en appuyant sur le bouton pendant 3 secondes, puis appuyez de nouveau sur le bouton pour mettre la machine en marche. Attendez maintenant environ 20 minutes pour permettre à la machine de refroidir après une utilisation intensive
- Il y a un temps d'attente pour observer un écoulement de l'orifice de la machine (dû à la lecture du code barres et l'ajout d'eau au café).
- Vérifier si la capsule est neuve et correctement insérée, et si la poignée est adéquatement verrouillée, puis appuyer sur le bouton.
- Remplir le réservoir d'eau, puis appuyer sur le bouton.
- Éteindre la machine en appuyant sur le bouton pendant 3 secondes, puis appuyer à nouveau pour remettre la machine sous tension. Ensuite, laisser la machine refroidir pendant environ 20 minutes après une utilisation prolongée.

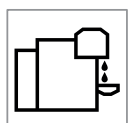

Le voyant clignote alternativement 2 clignotements et 1 pause en continu. La machine ne fonctionne pas.

- Pendant la préparation du Café ou d'un Espresso:
 - 1) Déverrouiller le levier, ouvrir la tête de la machine et vérifier qu'il n'y ait pas de capsules endommagées à l'intérieur.
 - 2) Vérifier que le levier est en position « VERROUILLÉ ».
 - 3) Vérifier que le réservoir d'eau est rempli.
- Pendant le détartrage, la vidange et le nettoyage:
 - 1) Vérifier que la capsule est éjectée.
 - 2) Vérifier que le levier est en position « VERROUILLÉ ».
- Durant la programmation du volume:
 - 1) Vérifier si une capsule a bien été insérée
 - 2) Se référer au chapitre correspondant
- Si le problème persiste;
 1. Déverrouiller le levier et ouvrir la tête de la machine.
 2. Remplacer la capsule (si nécessaire).
 3. Déconnecter le câble de la machine et le brancher au bout de 10 secondes.
 4. Fermer la tête et appuyer sur le bouton pour allumer la machine et appuyer de nouveau pour commencer la préparation de café. Si le problème persiste, appeler **Nespresso**.

Le voyant clignote de façon intermittente à 3 reprises, puis demeure allumé.

- Détartrage requis: une fois que l'alerte apparaît, l'utilisateur peut encore préparer quelques cafés avant que le détartrage ne devienne obligatoire.

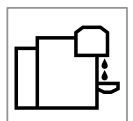
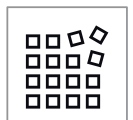

SPÉCIFICATIONS

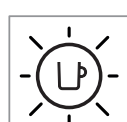
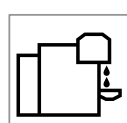
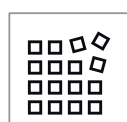
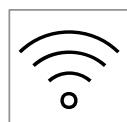

Puissance

US, CA: 120 V, 60 Hz, 1500 W
MX: 127 V~, 60 Hz, 1650 W

Fréquence

2.402–2.480 GHz

Puissance de sortie RF (EIRP)

Bluetooth 4 dBm Max. e.i.r.p. et Wi-Fi
<20 dMm max. e.i.r.p.

Dimensions (L x P x H)

219 x 356 x 265 mm / 8.6 x 14 x 10.4 pouces

Poids

Vertuo Pop+: 0,75 L / 25.4 oz liq
Vertuo Pop+ Deluxe: 3,7 kg / 8.1 lbs

Capacité du réservoir d'eau

Vertuo Pop+: 0,75 L / 25.4 oz liq
Vertuo Pop+ Deluxe: 1,1 L / 37.2 oz liq

Capacité du conteneur à capsules

Capacité du conteneur à capsules

CODES DE LA MACHINE

Nespresso

GCV6 GDV6

Breville

BNV520, BNV550,
BNV530, BNV560,
BNV540, BNV570

Delonghi

ENV92B, ENV92BAE,
ENV92Y, ENV92YAE,
ENV92AAE, ENV95S,
ENV95SAE

DA CLIC Y SELECCIONA TU IDIOMA

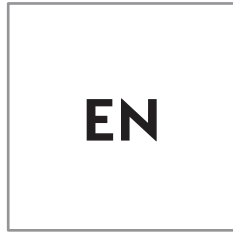

PRECAUCIONES DE SEGURIDAD



VISTA GENERAL



CONECTIVIDAD



PRIMER USO



PREPARACIÓN DE CAFÉ



AJUSTA EL VOLUMEN DE CAFÉ



LIMPIEZA



DESCALCIFICACIÓN



VACIADO



AJUSTES DE MÁQUINA



RESUMEN DE PARPADEO



SOLUCIÓN DE PROBLEMAS



ESPECIFICACIONES

PRECAUCIONES DE SEGURIDAD

PRECAUCIÓN: Antes de operar su máquina de café, favor de referirse a las instrucciones de seguridad para evitar posibles daños y lesiones.

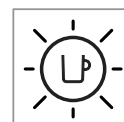
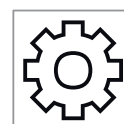
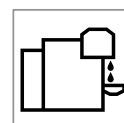
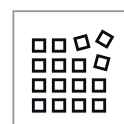
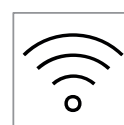
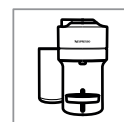

VISIÓN GENERAL

VISIÓN GENERAL DE LA MÁQUINA

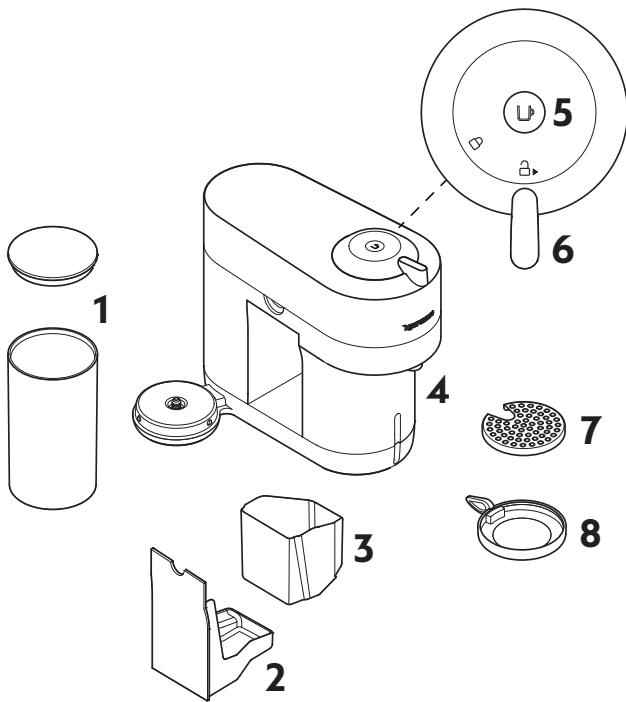

- 1 Tanque de agua y tapa
- 2 Charola de goteo
- 3 Contenedor de cápsulas usadas
- 4 Salida de café
- 5 Botón de encendido y apagado (ON/OFF) y café
- 6 Palanca de bloqueo y desbloqueo
- 7 Rejilla de goteo
- 8 Soporte para tazas ajustable

CONTENIDO



- 1 Máquina de café
- 2 Set de cápsulas de regalo
- 3 Brochure de bienvenida Nespresso
- 4 Instrucciones de seguridad
- 5 Guía de inicio rápido
- 6 Garantía

i Desempaque: Un poco de polvo puede estar presente en la superficie de la máquina debido al uso de materiales reciclados. Esto no representa un riesgo, solo retírelo con un paño seco y suave.

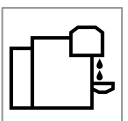
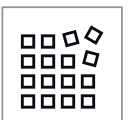

ABRIR / CERRAR

ABRIR

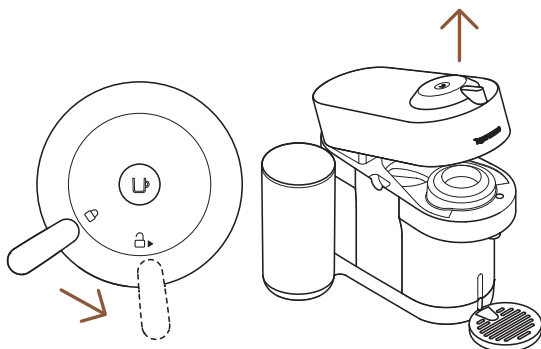

CERRAR

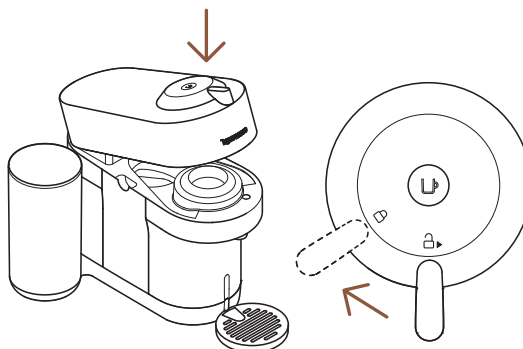

EL SISTEMA VERTUO

CÁPSULAS COMPATIBLES



S

Espresso
(40 ml)



M

Double Espresso
(80 ml)
Gran Lungo
(150 ml)



L

Mug
(230 ml)



XL

Alto, Cold Brew Style
(355 ml)
Carafe
(535 ml)

ACCESORIOS



Accesorios
compatibles



Espresso



Double Espresso



Gran Lungo



Mug



Reveal Glass



Accesorios no
compatibles



Alto



Carafe

Descubra nuestra colección completa de accesorios en:
www.nespresso.com

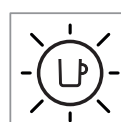
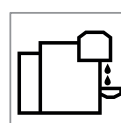
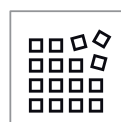
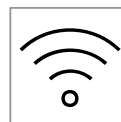

CONECTIVIDAD

¿POR QUÉ DEBERÍA CONECTAR SU MÁQUINA VERTUO POP+?

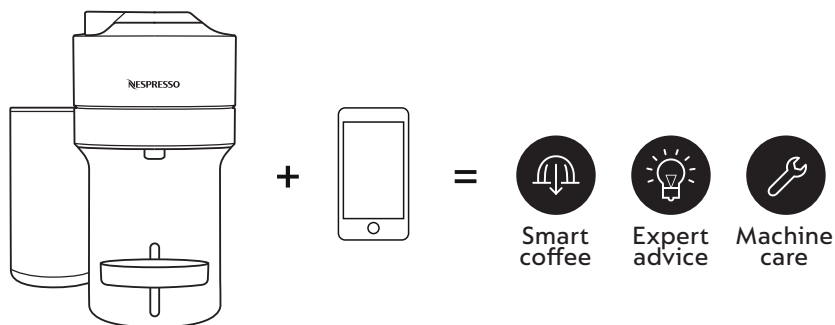

BENEFICIOS DE CONECTAR SU MÁQUINA VERTUO POP+

- **Café inteligente:** disfrute las innovaciones más recientes de **Nespresso** al mantener su máquina actualizada.
- **Consejos de expertos:** reciba consejos en tiempo real e instrucciones paso a paso sobre descalcificación, enjuague y limpieza de su máquina.
- **Cuidado de su máquina:** obtenga soporte y tutoriales para su máquina mediante su smartphone.

¿CÓMO CONECTAR SU MÁQUINA VERTUO POP+?

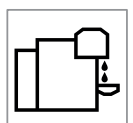



1 Descargue o actualice la App de **Nespresso**.



2 Ejecute la App de **Nespresso** en su smartphone o su tableta.

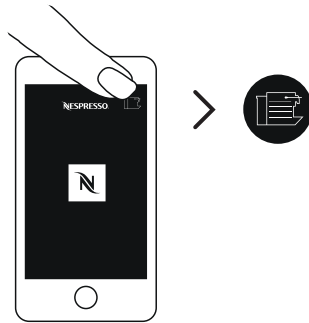

3 Presione el botón de máquina en la parte superior derecha de su pantalla.

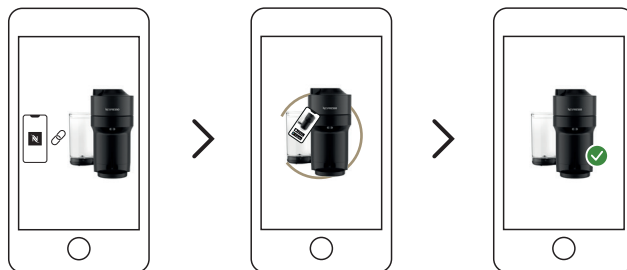

4 Siga las instrucciones mediante la App de **Nespresso**.

* AppStore® es una marca registrada de Apple Inc., y registrada en EUA y otros países.

** Google Play y el logo de Google Play son marcas registradas de Google LLC.

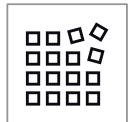

PRIMER USO

ENCENDIDO / APAGADO

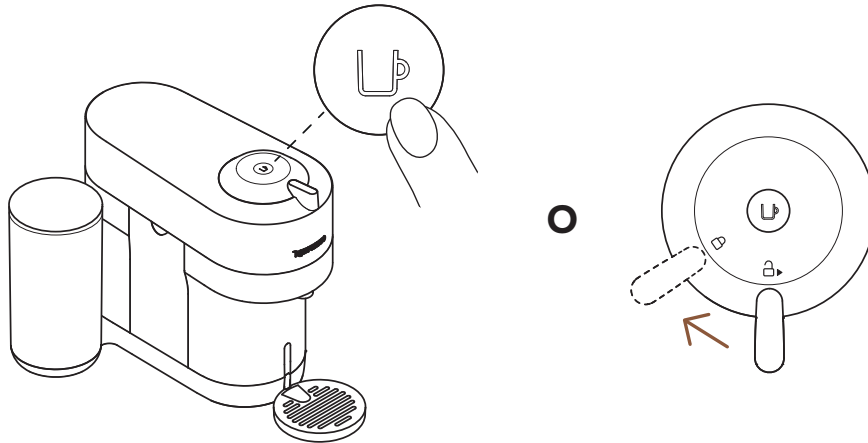

ENCENDIDO (ON)

Una vez que la máquina esté conectada, presione el botón una vez o mediante el cierre de la palanca en la posición de bloqueo (con el cabezal cerrado).

- i** La luz parpadeará por aproximadamente 30 segundos mientras la máquina está en calentamiento. Una vez que la luz esté fija, la máquina está lista para su uso.



APAGADO (OFF)

Para ahorrar energía, la máquina se apagará automáticamente después de 2 minutos sin uso.

- i** La máquina puede apagarse de manera manual en cualquier momento (cuando no esté en uso) al presionar y mantener el botón por 3 segundos.

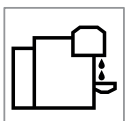
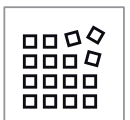

PRIMER ENJUAGUE

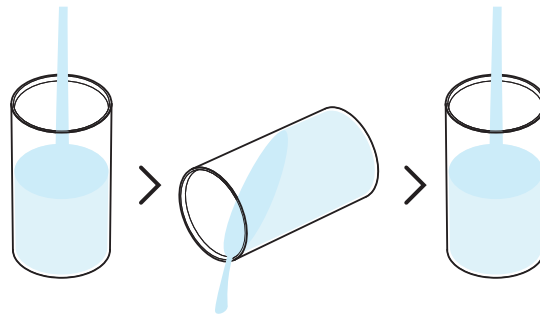

- 1** Enjuague el tanque de agua antes de llenarlo con agua potable fresca.

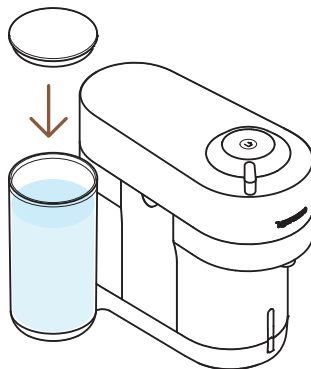

- 2** Cierre el tanque de agua con la tapa y coloque el tanque de agua en su posición en la máquina.



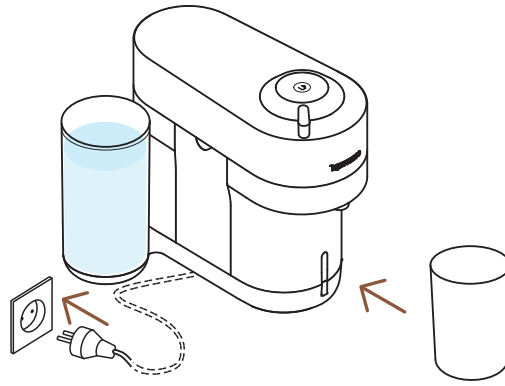

- 3** Conecte el cable de alimentación eléctrica, retire el soporte de tazas y coloque un contenedor vacío (de al menos 1 L) debajo de la salida de café.

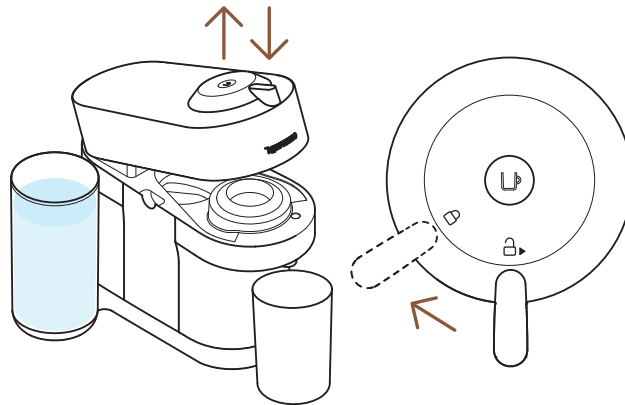

- 4** Abra y cierre la máquina. Asegure que la palanca está en la posición de bloqueo.

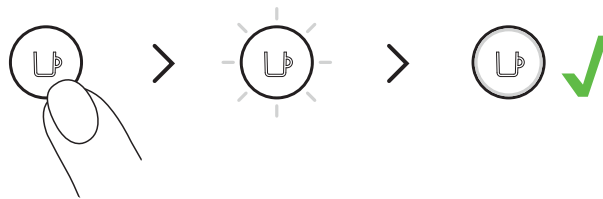

- 5** Encienda la máquina al presionar el botón una vez.

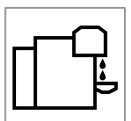

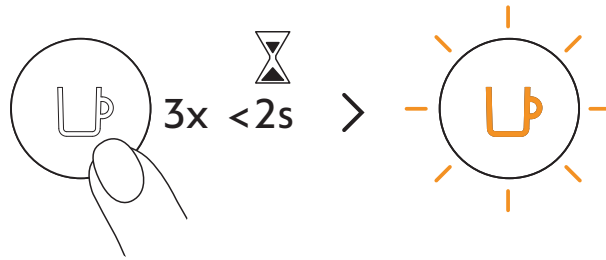

6 Presione el botón 3 veces en un periodo de 2 segundos.

i La máquina empezará el proceso de enjuague. Este proceso puede tomar hasta 7 minutos.

PRECAUCIÓN: Primero lea las precauciones de seguridad para evitar riesgos fatales o shock eléctrico e incendios. Asegure la conexión a tierra al conectar la máquina a la luz eléctrica.

i Al desempacar la máquina, retire la protección de plástico.

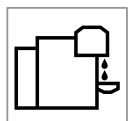
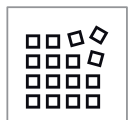

PREPARACIÓN DE CAFÉ

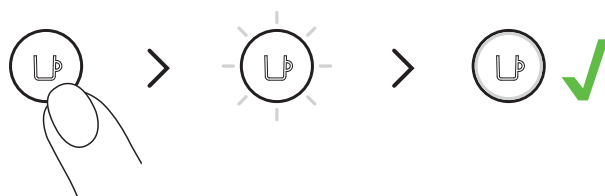

- 1** Encienda su máquina al presionar una vez el botón o al cerrar la palanca hacia la posición de bloqueo

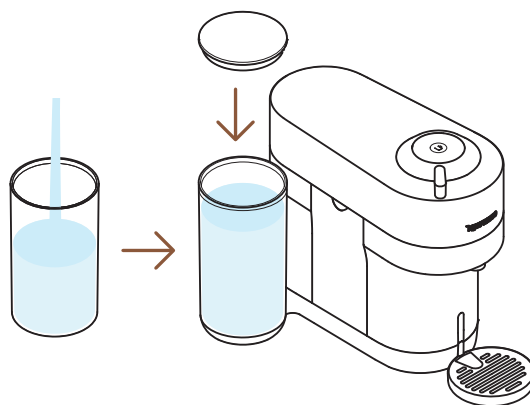

- 2** Llene el tanque de agua con agua potable y colóquelo nuevamente en su posición.

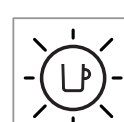
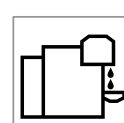
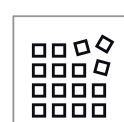
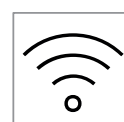
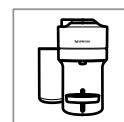

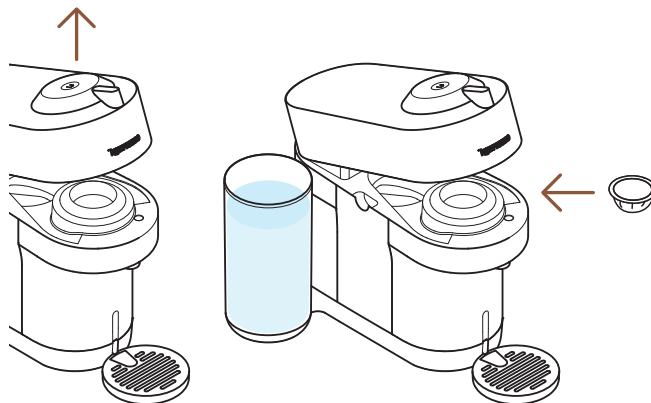

- 3** Abra la máquina e inserte una cápsula Vertuo.

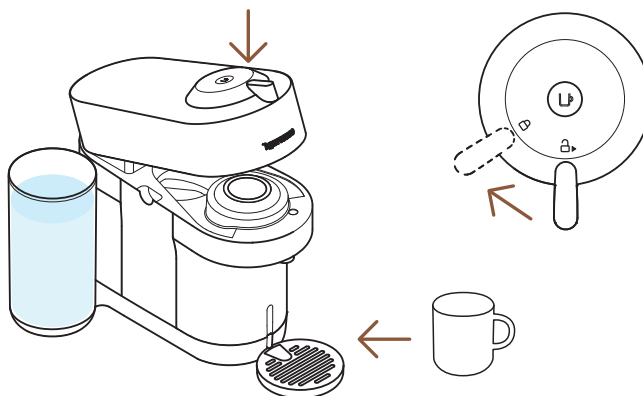

- 4** Cierre la máquina mediante el giro de la palanca hacia la posición de bloqueo y coloque una taza. El soporte de tazas puede ajustarse para acomodar su tamaño de taza.

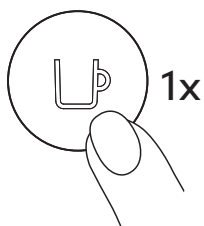

- 5** Inicie la extracción al presionar el botón una vez.

NOTA: Se acumular agua dentro del cabezal de la máquina. Por favor seque las partes visibles con un paño seco.

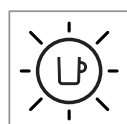
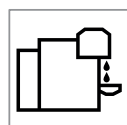
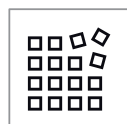
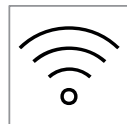

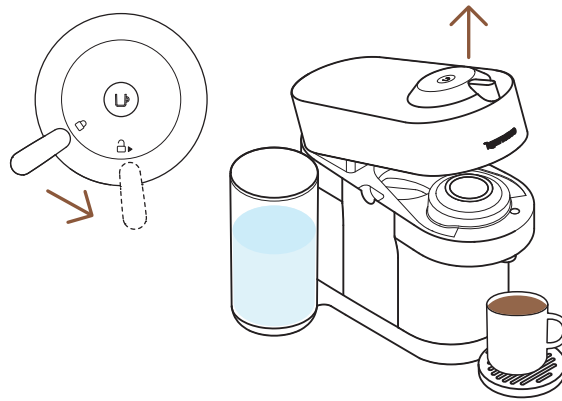

- 6** Cuando el café termine de extraerse, abra la máquina mediante el giro de la palanca hacia la posición de desbloqueo, retire la cápsula y disfrute su café.

DESCUBRE NUESTRA EXTRACCIÓN CONCENTRADA PARA RECETAS DE BARISTA

Con esta máquina, **Nespresso** te ofrece una función específica para concentrar tu extracción de café para crear tus propias recetas.

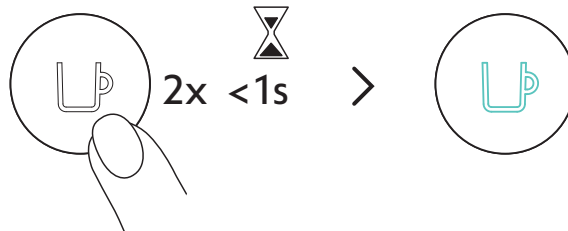

Con tu máquina encendida, rápidamente presiona el botón de café. Este, parpadeará en color turquesa y tu café se concentrará para aumentar el sabor y aroma de tu café con acompañantes (leche, cremador, sobre hielo...).

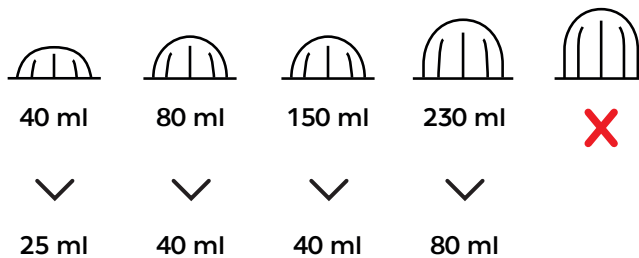

Descubre cómo mejorar tu máquina con nuestros Aeroccinos en www.nespresso.com

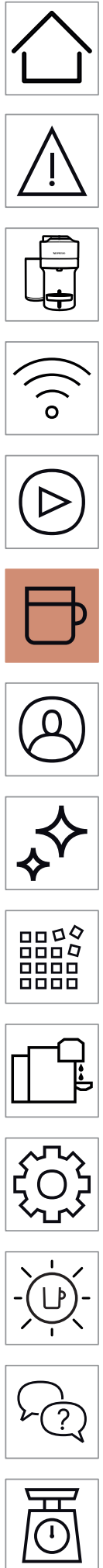

AJUSTA EL VOLUMEN DE CAFÉ

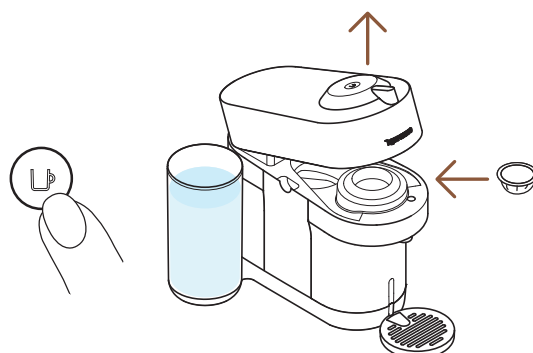

- 1 Abra la máquina e inserte una cápsula Vertuo.

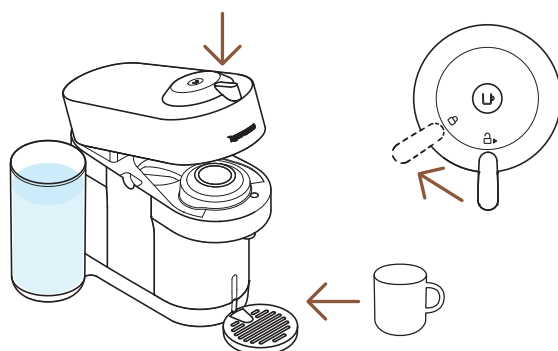

- 2 Cierre la máquina, gire la palanca hacia la posición de bloqueo y coloque una taza.

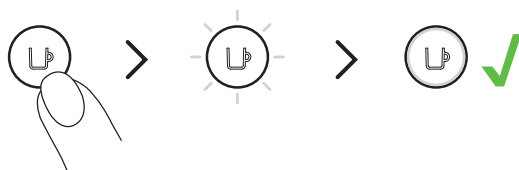

- 3 Mantenga presionado el botón hasta que alcance el volumen deseado. El volumen de agua ha sido programado para el tipo de cápsula usada durante el ajuste.

i La programación es específica para cada tipo de cápsula. Los tamaños de taza pueden ser programados desde 20 ml hasta 535 ml.

NOTA: Una vez que se programa el volumen deseado por el usuario, cada vez que ese tipo de cápsula sea colocada en la máquina, la preparación parará en el volumen programado por el usuario. Si desea restaurar los valores de fábrica, ve la sección **“Restablecer los valores de fábrica”**.

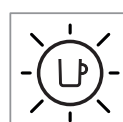
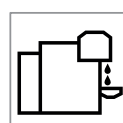
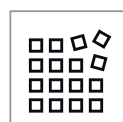
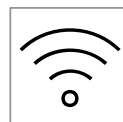
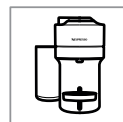

LIMPIEZA

Limpié su máquina mensualmente, cuando perciba residuos de café dentro del cabezal o después de un periodo largo sin uso.

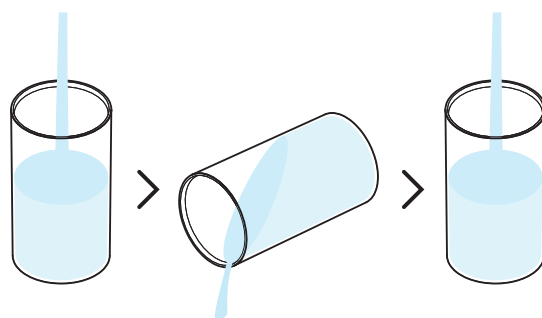

- 1** Enjuague y limpie el tanque de agua y la tapa llenándolo con agua potable fresca.

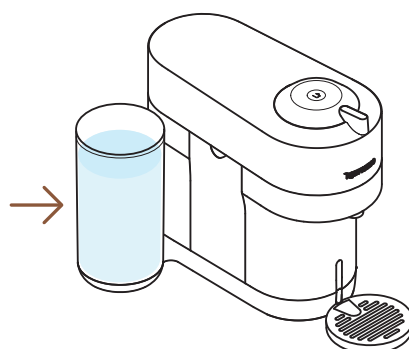

- 2** Coloque el tanque de agua de nuevo en la posición de la máquina.

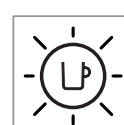
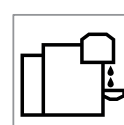
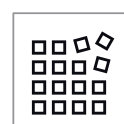
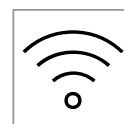
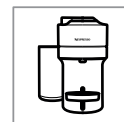

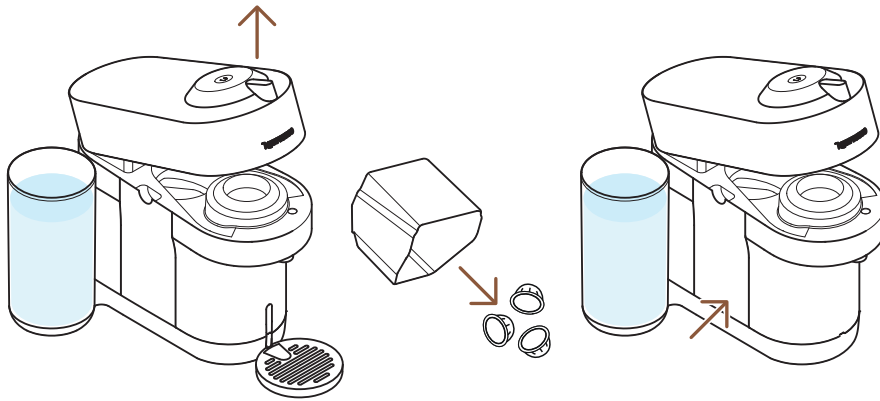

- 3** Abra la máquina y permita que la cápsula sea retirada. Vacíe el contenedor de cápsulas y colóquelo de nuevo en su lugar.

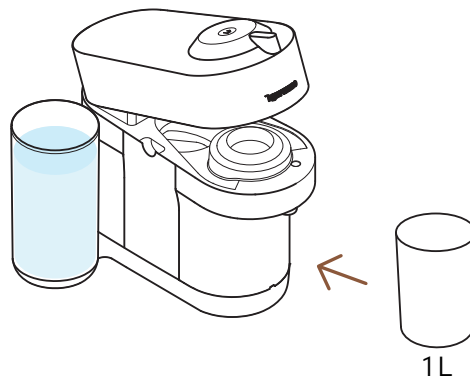

- 4** Retire el soporte de tazas y coloque un contenedor de al menos 1 L de capacidad debajo de la salida de café.

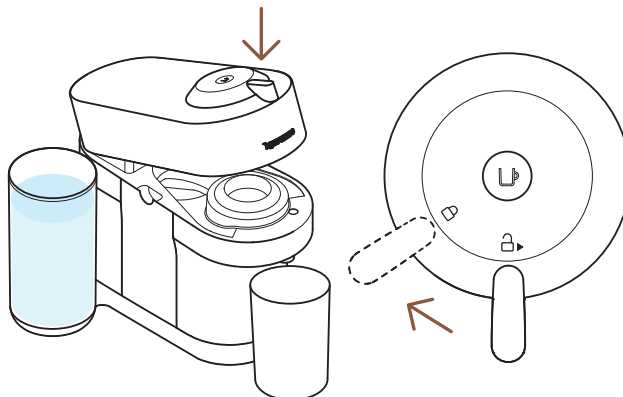

- 5** Cierre el cabezal y gire la palanca hacia la posición de cierre.

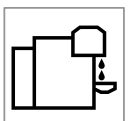

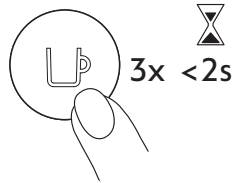

- 6** Con la máquina encendida, presione el botón 3 veces en los siguientes 2 segundos.

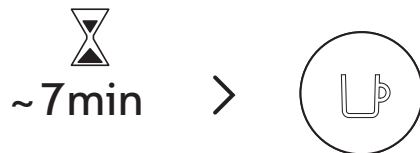

- 7** El procedimiento de limpieza se realizará automáticamente por aproximadamente 7 minutos. Una luz fija permanece cuando el proceso haya terminado.

- i** Toma aproximadamente 2 minutos antes de que el agua empiece a fluir por la salida de café. El procedimiento puede detenerse en cualquier momento al presionar el botón.

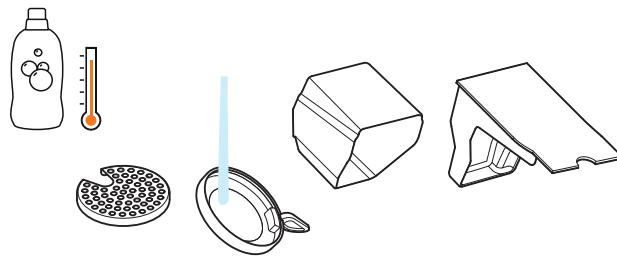

- 8** Lave el contenedor de cápsulas, el soporte de tazas y la charola de goteo con agua caliente y detergente sin aroma.

PRECAUCIÓN: No utilice agentes de limpieza abrasivos. No coloque la máquina en el lavavajillas. No sumerja el aparato o parte de él en agua.

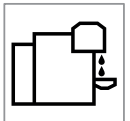

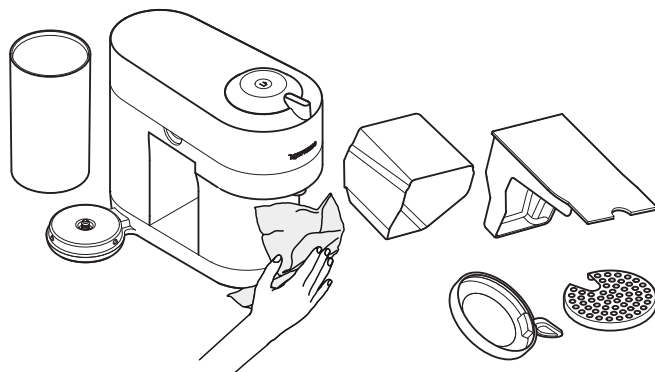

9 Seque la máquina con un paño limpio.

PRECAUCIÓN: Limpie la salida de café regularmente con un paño húmedo. Siempre utilice paños suaves para realizar la limpieza de la máquina.

NOTA: Se puede acumular agua dentro del cabezal durante el proceso de limpieza. Si esto pasa, seque las partes visibles con un paño limpio.

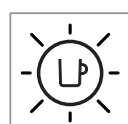
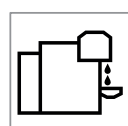
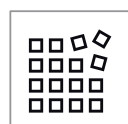
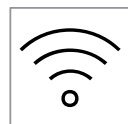

DESCALCIFICACIÓN

El proceso de descalcificación asegura que su máquina funcione apropiadamente durante su tiempo de vida y hará que su experiencia de café sea como el primer día. Su máquina le indicará cuando deba descalcificarla mediante el parpadeo de las luces en color naranja antes de la luz fija blanca.



i El proceso de descalcificación toma aproximadamente 20 minutos y no puede interrumpirse.

Necesitará:

- El kit de descalcificación disponible en www.nespresso.com
- Un contenedor vacío de al menos 1 L de capacidad

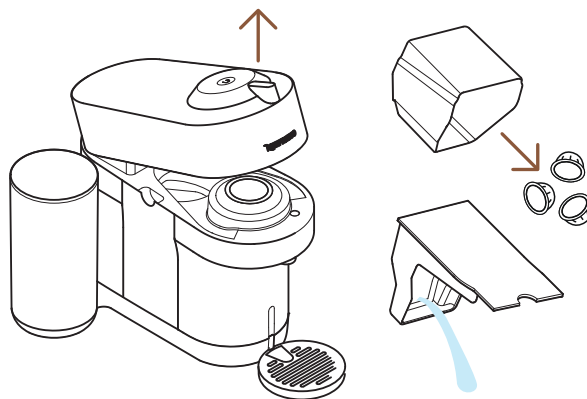

1 Abra el cabezal y permita que la cápsula sea retirada. Vacíe el contenedor de cápsulas y la charola de goteo y colóquelas nuevamente en su lugar.



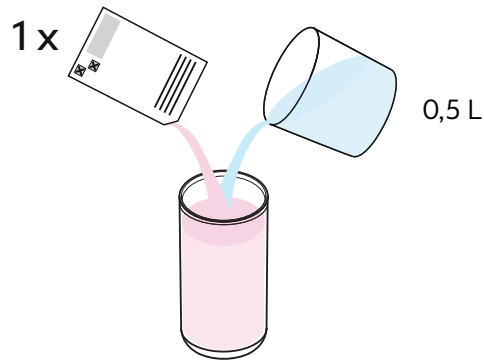

- 2** Llene el tanque de agua con 0,5 L de agua y añada 1 unidad del líquido descalcificante de **Nespresso**.

PRECAUCIÓN: La solución descalcificante puede ser dañina. Evite el contacto con los ojos, la piel y las superficies.

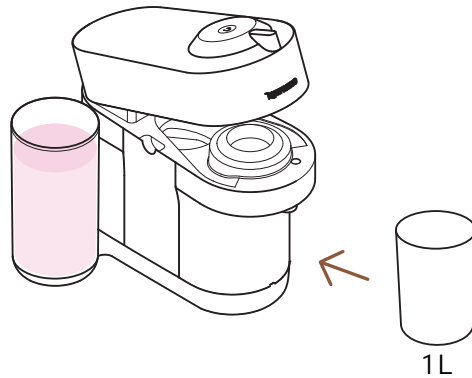

- 3** Retire el soporte de tazas y coloque un contenedor vacío de al menos 1 L de capacidad debajo de la salida de café.

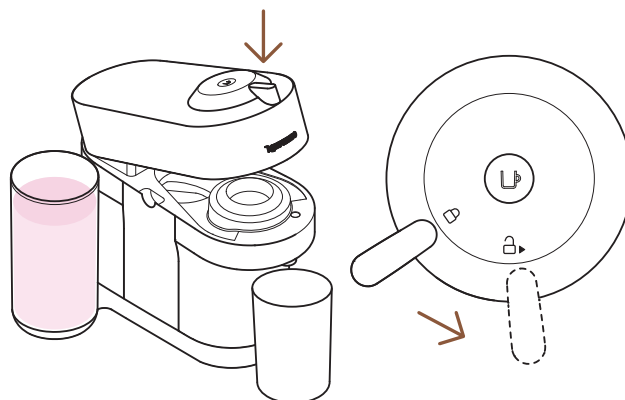

- 4** Con la máquina encendida, cierre el cabezal y mantenga la palanca en la posición de desbloqueo.

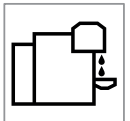

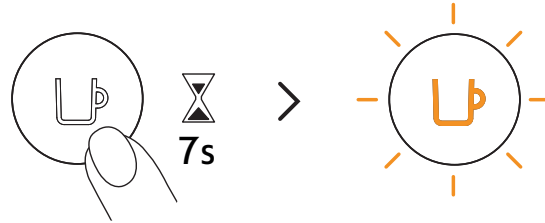

- 5** Mantenga el botón presionado por al menos 7 segundos. El botón empezará a parpadear en color naranja rápidamente.

PRECAUCIÓN: Cuenta con 45 segundos para entrar al modo de descalcificación, de lo contrario, la máquina regresará al modo de extracción.

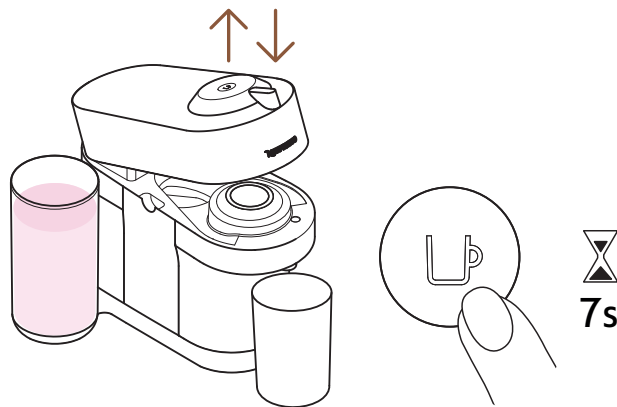

- 6** Abra y cierre el cabezal de la máquina y deje la palanca en la posición de desbloqueo. Mantenga el botón por al menos 7 segundos.

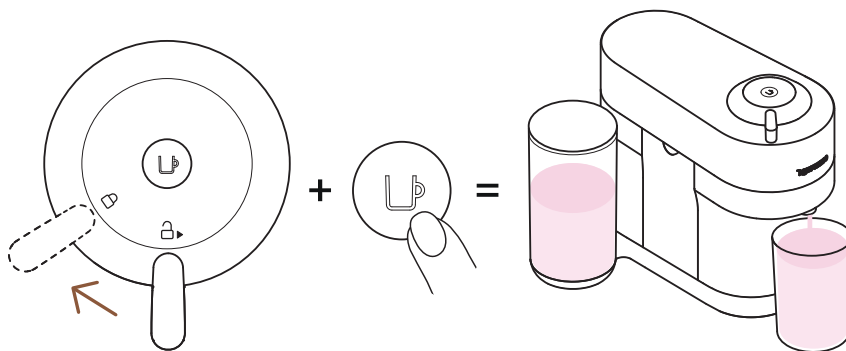

- 7** Gire la palanca hacia la posición de bloqueo y presione una vez el botón.

i La máquina se detendrá automáticamente cuando el proceso esté completo.



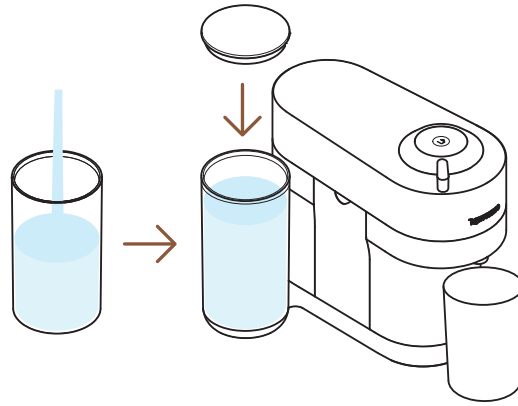

- 8** Ahora es momento de enjuagar la máquina. Enjuague el tanque de agua y llénelo con agua potable. Colóquelo de nuevo en su lugar.

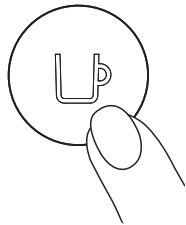

- 9** Presione el botón para enjuagar la máquina. Cuando el botón parpadee rápidamente, el proceso de descalcificación está completo.

- i** La máquina se detendrá automáticamente cuando el proceso esté completo.

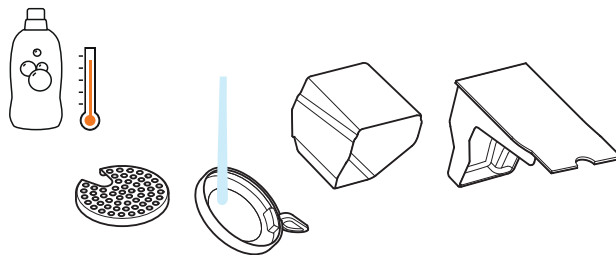

- 10** Lave el contenedor de cápsulas, el soporte de tazas y la charola de goteo con agua caliente y detergente sin aroma.

PRECAUCIÓN: No utilice jabón o limpiadores abrasivos. No coloque la máquina en el lavavajillas. No sumerja la máquina o una parte de la máquina en agua.

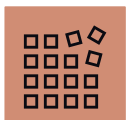

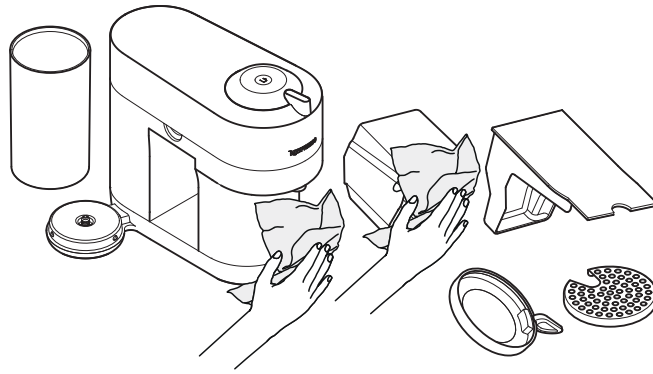

11 Seque la máquina con un paño limpio.

PRECAUCIÓN: No utilice agentes de limpieza abrasivos. No coloque la máquina en el lavavajillas, ni sumerja el aparato o parte de él en agua.

NOTA: Se puede acumular agua dentro del cabezal durante la limpieza, si esto pasa, seque las partes visibles con un paño limpio.

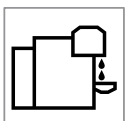
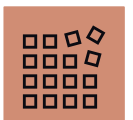

VACIADO

El vaciado del sistema es un proceso que puede ser realizado antes de un periodo sin uso, para protección contra las heladas o previo al envío de la máquina a servicio técnico.

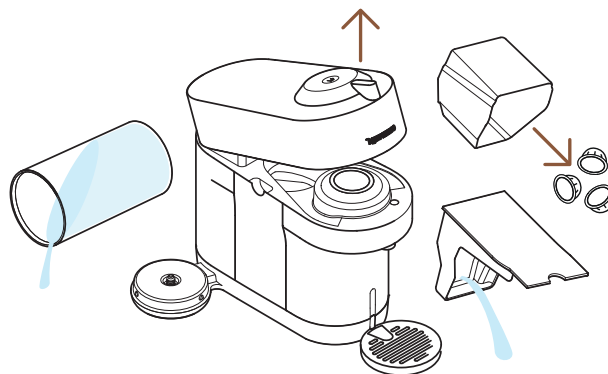

- 1** Vacíe el tanque de agua, abra el cabezal de la máquina y retire la cápsula usada. Vacíe el contenedor de cápsulas y la charola de goteo.

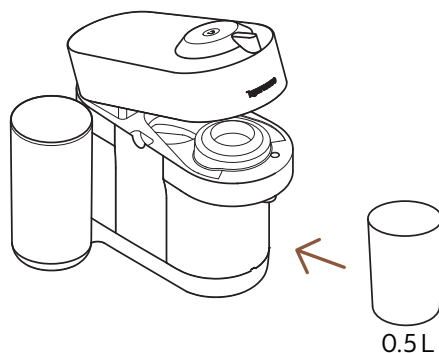

- 2** Coloque los removibles de nuevo en su lugar y retire el soporte de tazas y coloque un contenedor vacío de al menos 0,5 L de capacidad debajo de la salida de café.

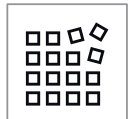

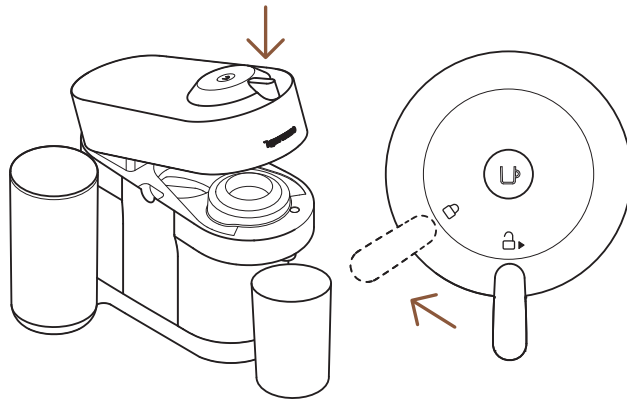

- 3** Con la máquina conectada, cierre el cabezal y coloque la palanca en la posición de bloqueo.

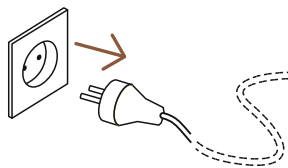

- 4** Desconecte la máquina.

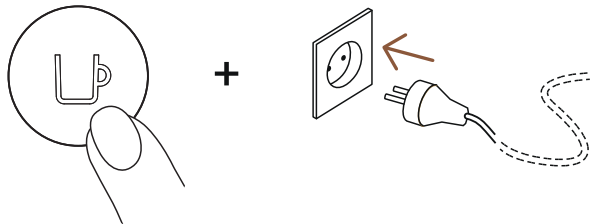

- 5** Mantenga presionado el botón mientras vuelve a conectar la máquina.

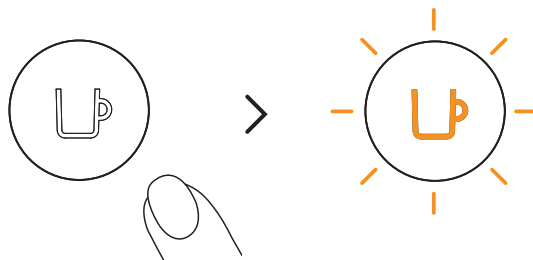

- 6** Deje de presionar el botón. Parpaderá en color naranja y se iniciará el proceso.

- i** Tomará aproximadamente 30 segundos para completar el proceso. La máquina se apaga automáticamente cuando el proceso está terminado.

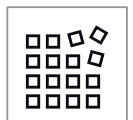

AJUSTES DE LA MÁQUINA



RESTABLECER LOS VALORES DE FÁBRICA

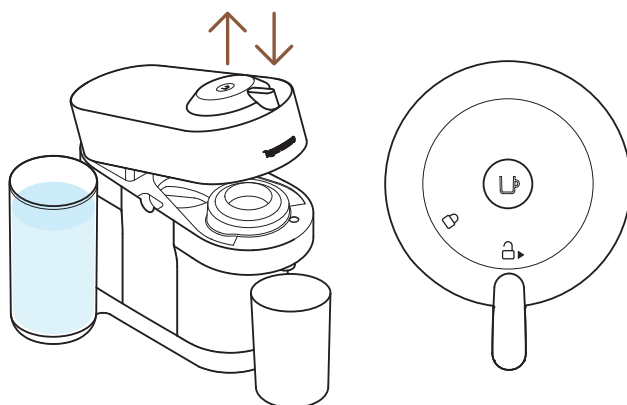

- 1 Con la máquina conectada, cierre el cabezal antes de colocar la palanca en la posición de bloqueo.

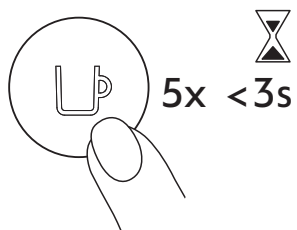

- 2 Presione el botón 5 veces en 3 segundos. La máquina ahora cuenta con los ajustes de fábrica.

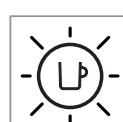
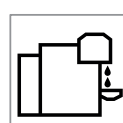
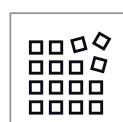
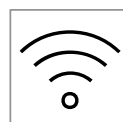
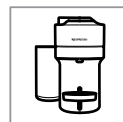

BLUETOOTH Y WIFI DE LA MÁQUINA

La máquina cuenta con un módulo de conectividad que está encendido por default. Brinda opciones adicionales, mejorando su experiencia de café. Para desconectar el módulo de conectividad, siga los siguientes pasos:

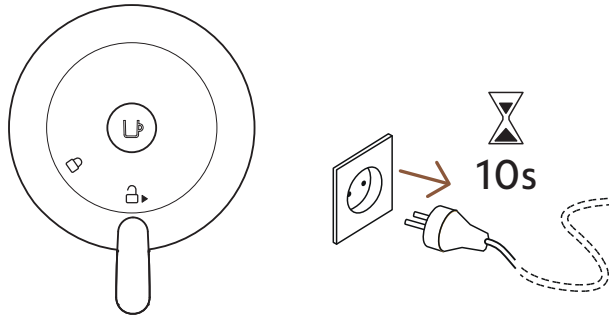

- 1 Con el cabezal de la máquina cerrado y la palanca en la posición de desbloqueo, desconecte la máquina por al menos 10 segundos.

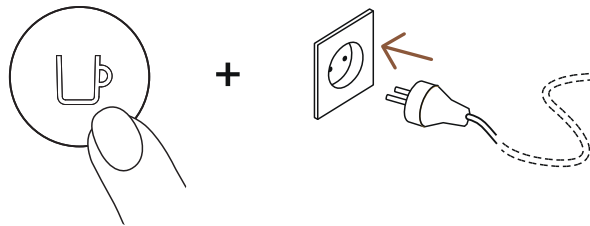

- 2 Mantenga presionado el botón mientras vuelve a conectar la máquina. El botón parpadeará en color naranja para confirmar que el módulo de conectividad está desactivado.
- i** Siga los mismos pasos para encender de nuevo el módulo de conectividad. El botón parpadeará en color blanco para confirmar que se ha reactivado el módulo.

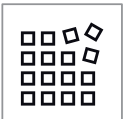
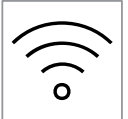

RESUMEN DE PARPADEO

¿Desea saber más sobre el parpadeo de Vertuo Pop+?
Lo invitamos a ver el siguiente video:

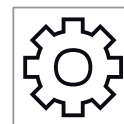
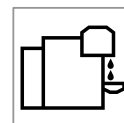
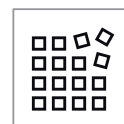
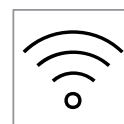
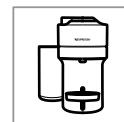

SOLUCIÓN DE PROBLEMAS

No hay luz en el botón

- No hay luz en el botón: La máquina se apagó automáticamente. Presione el botón o desbloquee la máquina.
- Revise el conector, el voltaje y los fusibles.

No extrae café ni agua

- Revise que el tanque de agua esté lleno.
- Revise que una cápsula nueva haya sido colocada en el cabezal y que la palanca está correctamente cerrada y presione el botón.
- Descalcifique de ser necesario.
- Abra el cabezal de la máquina y permita que la cápsula usada se retire. Realice la limpieza como lo menciona la sección de limpieza.

El café no está caliente

- Precaliente la taza con agua caliente de la llave.
- Descalcifique de ser necesario.

Fuga o flujo de café anormal

- Revise que el tanque de agua está bien posicionado.
- Descalcifique de ser necesario.

La máquina se apaga

- Para ahorrar energía, la máquina se apaga automáticamente después de 2 minutos sin uso.
- La máquina puede apagarse en cualquier momento al presionar el botón durante 3 segundos.

Hay restos de café en la taza

- Realice el proceso de limpieza dos veces.
- Vea la sección “Limpieza”.

La máquina no inicia y tiene una luz fija. Si parpadea, vea los siguientes puntos.

- Revise que la palanca está correctamente cerrada.
- Si desea preparar café, revise que se haya colocado una cápsula nueva en el cabezal y que la palanca de bloqueo está correctamente cerrada.
- Si está en el proceso de limpieza, descalcificación o vaciado, revise que no haya cápsulas en el cabezal, cierre la máquina y asegure que la palanca está en la posición de bloqueo. Presione el botón para iniciar el proceso.

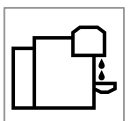
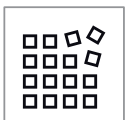

La máquina no inicia la extracción y las luces parpadean alternadamente. 1 parpadeo, 1 pausa

Las luces parpadean mientras se extrae café

La luz parpadea y la máquina no funciona

Las luces parpadean alternadamente. 2 parpadeos y 1 pausa. La máquina no inicia la extracción.

- Llene el tanque de agua y presione el botón para iniciar la extracción.
- Verifique que la palanca está correctamente bloqueada.
- Si el café fluye de manera normal, indica que la máquina funciona de manera correcta.
- Si solo fluye agua, la máquina está procesando la solicitud de limpieza, descalcificación o vaciado. Refiérase a la sección que corresponda.
- Apague la máquina presionando el botón por 3 segundos y después presiónelo de nuevo para encenderla. Ahora espere aproximadamente 20 minutos para permitir que la máquina se enfríe después de un uso continuo
- Tomará algo de tiempo antes de que el café fluya por la salida, esto, por la lectura del código de barras y el remojo del café.
- Revise que se haya colocado una cápsula nueva en el cabezal y que la palanca se encuentra en la posición de bloqueo.
- Llene el tanque de agua y presione el botón para iniciar.
- Apague la máquina presionando el botón por al menos 3 segundos. Prenda nuevamente la máquina al presionar el botón y espere aproximadamente 20 minutos para permitir que la máquina se enfríe después de un uso constante.
- Durante la preparación regular de café:
 - 1) Desbloquee la palanca y abra el cabezal para revisar que la cápsula no está dañada.
 - 2) Revise que la palanca está en la posición de bloqueo
 - 3) Revise que el tanque de agua esté lleno
- Durante la descalcificación:
 - 1) Revise que no haya cápsulas en el cabezal
 - 2) Revise que la palanca está en la posición de bloqueo
- Durante la programación de volumen:
 - 1) Revise que la cápsula está correctamente colocada
 - 2) Refiérase a la sección correspondiente

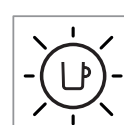
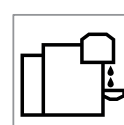
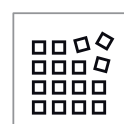
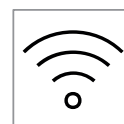
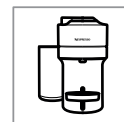

**La luz parpadea
alternadamente 3 veces
y después está fija**

- Si el problema persiste:
 - 1) Desbloquee la máquina y abra el cabezal.
 - 2) Reemplace la cápsula (de ser necesario).
 - 3) Desconecte la máquina de la luz y conéctela después de 10 segundos.
 - 4) Cierre el cabezal y presione el botón para encenderla; presione nuevamente el botón para iniciar la extracción
 Si el problema persiste, llame a **Nespresso**.
- Descalcificación necesaria: la máquina puede ser utilizada unas pocas veces más antes de que la descalcificación se vuelva necesaria.

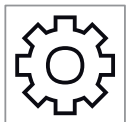

ESPECIFICACIONES

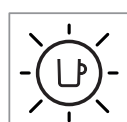
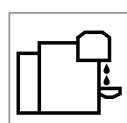
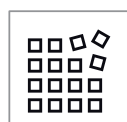
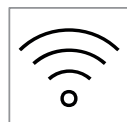

Voltaje

US, CA: 120 V, 60 Hz, 1500 W
MX: 127 V~, 60 Hz, 1650 W

Frecuencia

2.402–2.480 GHz

Radiofrecuencia

Bluetooth 4 dBm Máx. e.i.r.p. y Wi-Fi
<20 dMm máx. e.i.r.p.

Dimensiones (W x D x H)

219 x 356 x 265 mm

Peso

Vertuo Pop+: 3,6 kg
Vertuo Pop+ Deluxe: 3,7 kg

Capacidad del tanque de agua

Vertuo Pop+: 0,75 L
Vertuo Pop+ Deluxe: 1,1 L

Capacidad del contenedor de cápsulas

8 espresso o 5 mug capsules

CÓDIGOS DE MÁQUINA

Nespresso

GCV6 GDV6

Breville

BNV520, BNV550,
BNV530, BNV560,
BNV540, BNV570

Delonghi

ENV92B, ENV92BAE,
ENV92Y, ENV92YAE,
ENV92AAE, ENV95S,
ENV95SAE

